

Context Number:

2861

Level No.s
TBM 11.40
B/S -0.28
IH 11.12

Level No.s
TBM
B/S
IH

Level No.s
TBM
B/S
IH

Level No.s
TBM
B/S
IH

No.	F/S	R/L (m OD)	No.	F/S	R/L (m OD)	No.	F/S	R/L (m OD)	No.	F/S	R/L (m OD)
1	3.95	7.17	6	4.51	6.61						
2	4.50	6.62	7	/	6.30						
3	4.49	6.63	8	/	6.79						
4	4.44	6.68	9	4.60	6.52						
5	4.39	6.73									

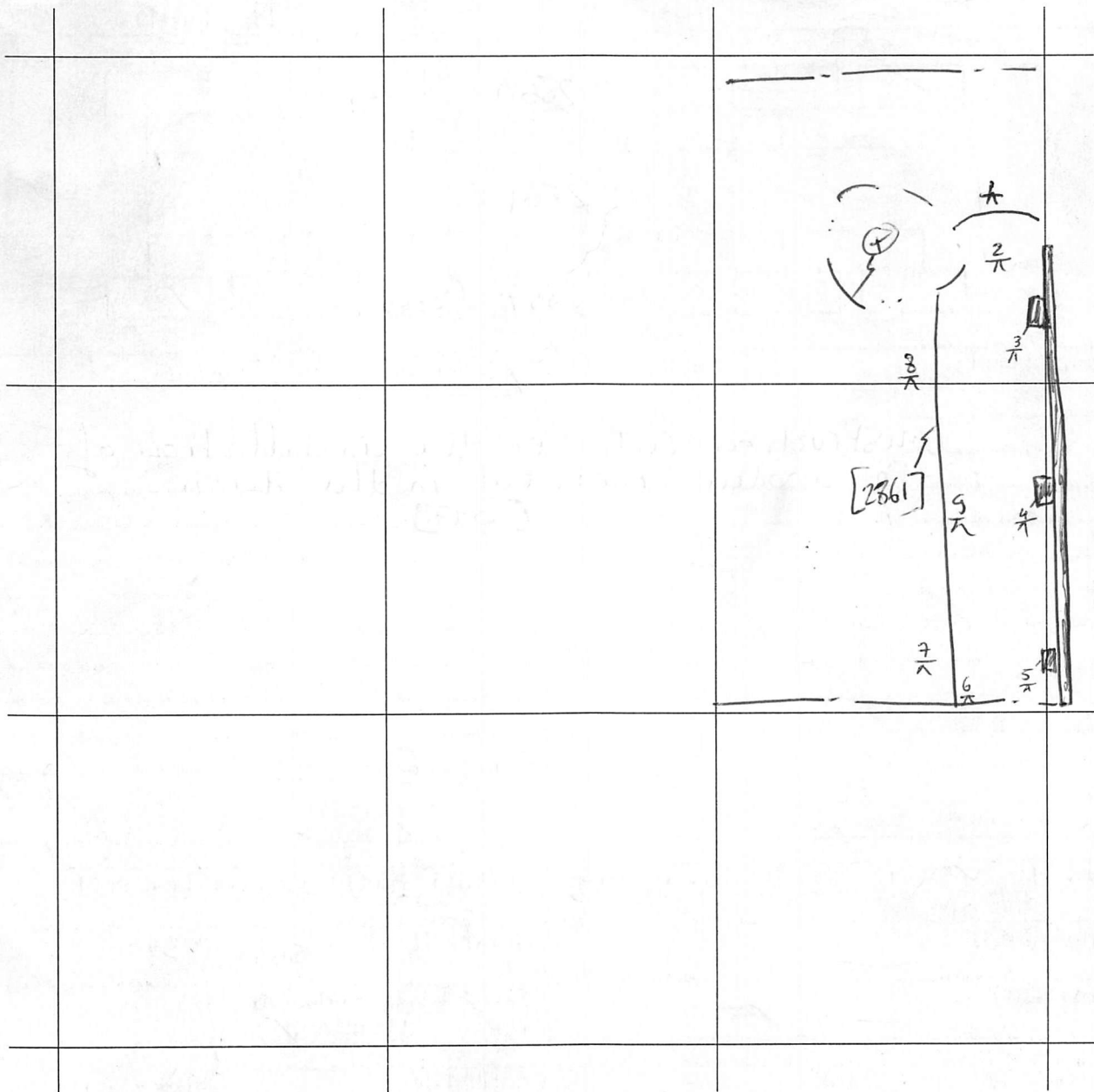

Site Code: MNO12	Location: B B	Grid Sq: 130/105	Context Type: CUT	Context Number: 2861
Deposit				Cut
1. Compaction				1. Shape in Plan
2. Colour				2. Corners
3. Composition				3. Dimensions
4. Inclusions	2 OF 2			4. Break of slope – Top
5. Interface				5. Sides
6. Dimensions				6. Break of slope – Base
7. Other Comments				7. Base
8. Method/Conditions	Text	SEE 1 OF 2		8. Orientation
				9. Inclination
				10. Truncation
				11. Other comments
				Max Level: m OD
				Min Level: m OD

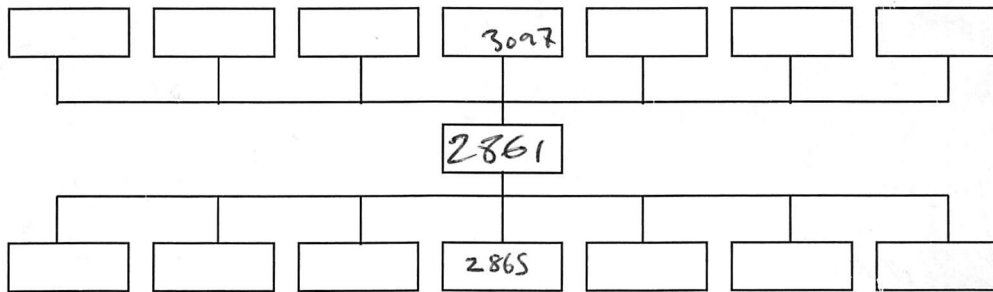

Interpretation:	Internal	External	Structural
Cut for the installation of the wooden revetment in the ditch [3097]			
2 OF 2			
Context same as:			

Finds: None <input type="checkbox"/> Pot <input type="checkbox"/> Bone <input type="checkbox"/> Glass <input type="checkbox"/> Metal <input type="checkbox"/> CBM <input type="checkbox"/> Flint <input type="checkbox"/> Wood <input type="checkbox"/> Leather <input type="checkbox"/>	
Other (specify):	
Sample No(s):	Drawing No(s): (x)
Photo No(s):	Sketch/levels overleaf: <input type="checkbox"/> Transferred to plan: <input type="checkbox"/>

Compiled by: AL	Date: 24-4-2015	Checked by: - studies	Tick when entered in database: <input type="checkbox"/>
---------------------------	---------------------------	---------------------------------	---

2012

Context Number:
2861

Level No.s
TBM 11.40
B/S 0.23
IH 11.17 m OD

Level No.s
TBM
B/S
IH

Level No.s 25 → 28
TBM 8.00
B/S 1.52
IH ~~6.12~~ 9.52 m

Level No.s
TBM
B/S
IH

No.	F/S	R/L (m OD)	No.	F/S	R/L (m OD)	No.	F/S	R/L (m OD)	No.	F/S	R/L (m OD)
10	3.99	7.18	15	3.84	7.33	20	4.41	6.76	25	1.76	7.76
11	4.15	6.95	16	4.00	7.17	21	4.50	6.67	26	1.87	7.65
12	4.36	6.81	17	4.51	6.66	22	4.48	6.77	27	1.91	7.61
13	4.34	6.83	18	4.43	6.74	23	4.53	6.64	28	1.92	7.60
14	3.75	7.42	19	4.49	6.68	24	4.58	6.59			

