

| | | | | |
|----------------------------|--|--|-----------------------------|--------------------------------|
| Site Code: MNO12 | Location: B | Grid Sq: 110/205 115/205 110/210 115/210 | Context Type: DEP | Context Number: 2667 |
| Deposit | ① FIRM ② REDDISH BROWN ③ CLINWER / CLAY WITH MORTAR ④ OCCASIONAL GRAVEL. OCCASIONAL RED BRICK FRAGS. OCCASIONAL SHELVES | | | Cut |
| 1. Compaction | | | | 1. Shape in Plan |
| 2. Colour | | | | 2. Corners |
| 3. Composition | | | | 3. Dimensions |
| 4. Inclusions | | | | 4. Break of slope - Top |
| 5. Interface | | | | 5. Sides |
| 6. Dimensions | | | | 6. Break of slope - Base |
| 7. Other Comments | | | | 7. Base |
| 8. Method/Conditions | Text ⑤ GOOD | | | 8. Orientation |
| | | | | 9. Inclination |
| | ⑥ 3m x 5m x 0.2m APPROX. COVERS TO END OF SM SLOT. 5.40m MAX E/W x 5.00m N/S | | | 10. Truncation |
| | | | | 11. Other comments |
| | ⑦ | | | |
| | | | | Max Level: m OD |
| | ⑧ MATTOCK | | | Min Level: m OD |

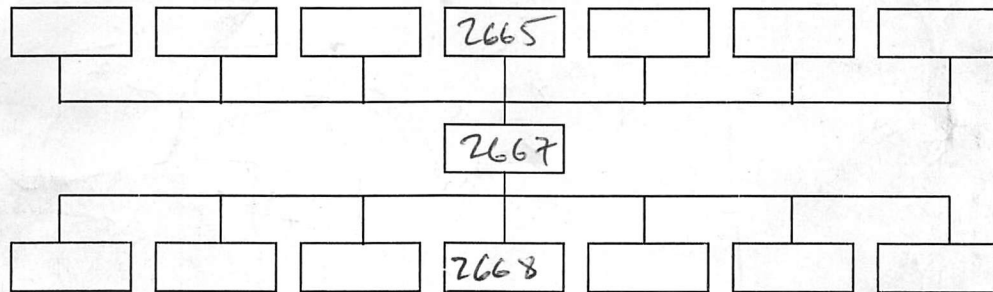

| | | | |
|--|----------|----------|------------|
| Interpretation: | Internal | External | Structural |
| DUMP LAYER TOWARDS W OF SITE. ABOVE SPLIT BETWEEN 2 LAYERS OF CLINWER PART OF GENERAL MOUND RAISING / DE SIDE DRAINING / FIRING UP OF DITCH AREA. | | | |
| Context same as: | | | |

| | | | |
|--|---|------------------------|---|
| Finds: None <input type="checkbox"/> Pot <input type="checkbox"/> Bone <input type="checkbox"/> Glass <input type="checkbox"/> Metal <input type="checkbox"/> CBM <input type="checkbox"/> Flint <input type="checkbox"/> Wood <input type="checkbox"/> Leather <input type="checkbox"/> Other (specify): | | | |
| Sample No(s): | Drawing No(s): 2667 (x 4) | | |
| Photo No(s): | Sketch/levels overleaf: <input type="checkbox"/> Transferred to plan: <input type="checkbox"/> | | |
| Compiled by: BSS | Date: 25/2/15 | Checked by: 27/6/15 | Tick when entered in database: <input type="checkbox"/> |

2.36
2.63
2.66

Context Number:
2667

| | | | |
|------------------|------------------|------------|------------|
| Level No.s | Level No.s 10-16 | Level No.s | Level No.s |
| TBM 11.80 11.50 | TBM 11.80 11.50 | TBM | TBM |
| B/S -0.78 -0.76 | B/S -0.23 -0.23 | B/S | B/S |
| IH 1.08 2.10 7.2 | IH 1.57 11.27 | IH | IH |

| No. | F/S | R/L (m OD) | No. | F/S | R/L (m OD) | No. | F/S | R/L (m OD) | No. | F/S | R/L (m OD) |
|-----|------|------------|-----|------|------------|-----|------|------------|-----|------|------------|
| 1 | 1.75 | 9.3827 | 6 | 1.44 | 9.6258 | 11 | 2.30 | 9.27 | 16 | 1.98 | 9.69 |
| 2 | 1.46 | 9.6256 | 7 | 1.60 | 9.42 | 12 | 2.17 | 9.40 | | | |
| 3 | 1.76 | 9.3226 | 8 | 1.60 | 9.42 | 13 | 2.07 | 9.50 | | | |
| 4 | 1.41 | 9.4961 | 9 | 1.66 | 9.36 | 14 | 2.00 | 9.57 | | | |
| 5 | 1.81 | 9.27 | 10 | 2.40 | 9.17 | 15 | 1.90 | 9.77 | | | |

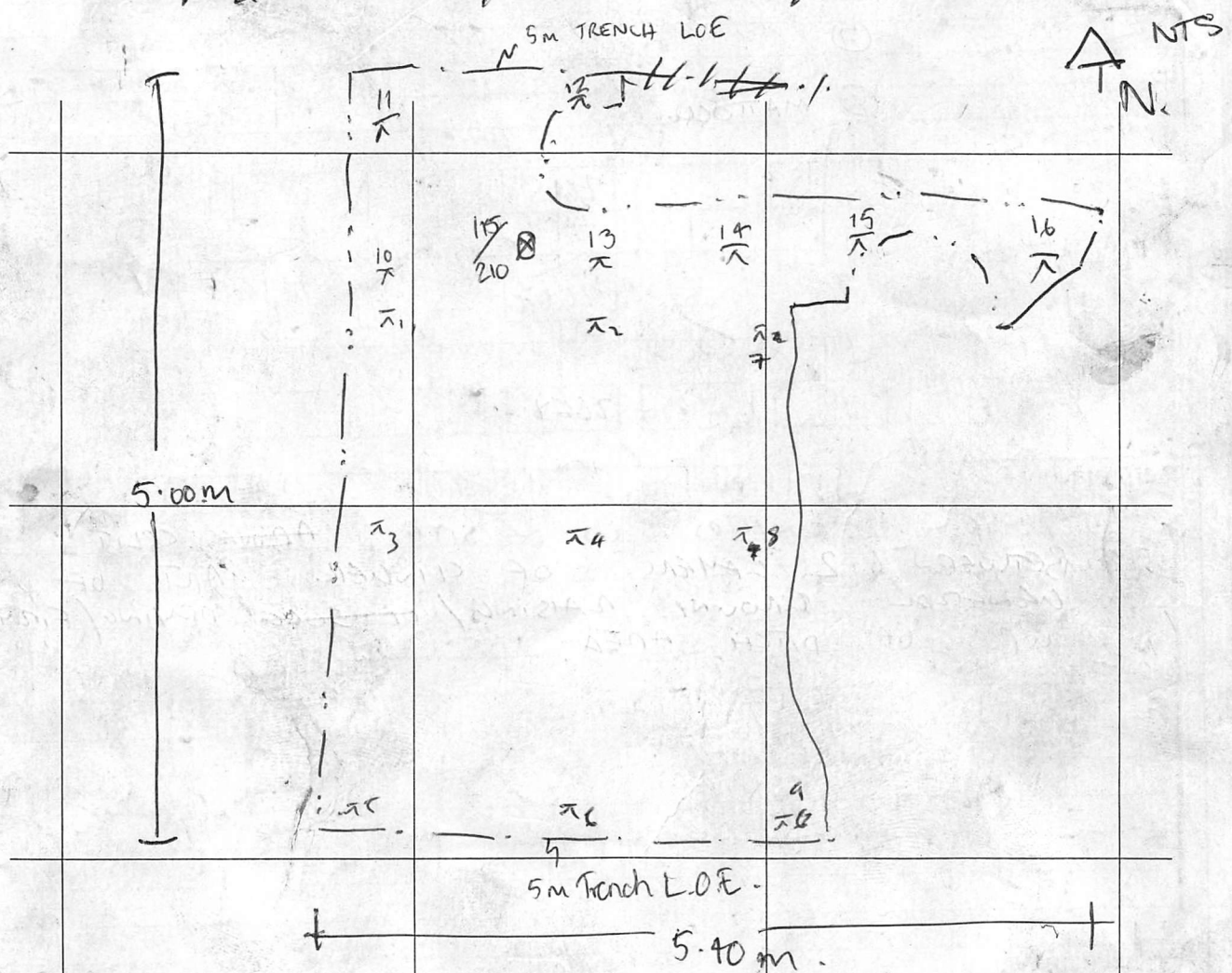

| | | | | | |
|-----|------|----|------|----|------|
| (R) | | | | | |
| 1 | 8.97 | 6 | 9.28 | 11 | 8.97 |
| 2 | 8.26 | 7 | 9.12 | 12 | 9.10 |
| 3 | 8.96 | 8 | 9.12 | 13 | 9.20 |
| 4 | 9.31 | 9 | 9.06 | 14 | 9.27 |
| 5 | 8.97 | 10 | 8.87 | 15 | 9.47 |
| | | | | 16 | 9.39 |