

Site Code: MNO12	Location: B	Grid Sq: 110/210	Context Type: DEP	Context Number: 2652
Deposit	(1) COMPACT FIRM (2) MID YELLOWISH BROWN (3) MORTAR + SAND (4) MODERATE RED BRICK + TILE 50-150mm			Cut
1. Compaction				1. Shape in Plan
2. Colour				2. Corners
3. Composition				3. Dimensions
4. Inclusions				4. Break of slope - Top
5. Interface				5. Sides
6. Dimensions				6. Break of slope - Base
7. Other Comments				7. Base
8. Method/Conditions	Text			8. Orientation
	(5) 6000			9. Inclination
	(6) in x in approx.			10. Truncation
	(7)			11. Other comments
	(8)			
	(9) MATTOCK			
				Max Level: 9.65 m OD
				Min Level: 9.88 m OD

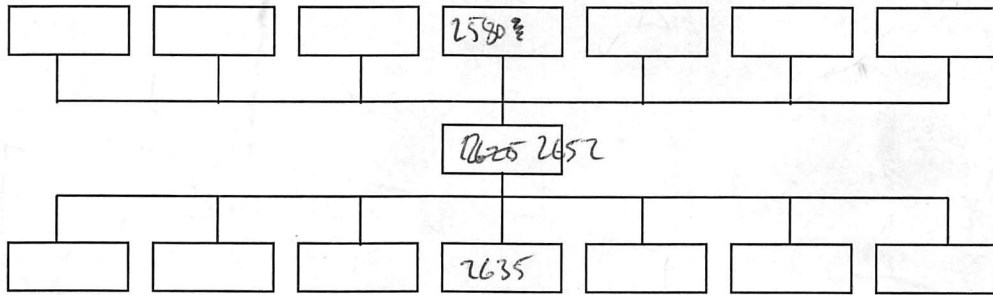

Interpretation:	Internal	External	Structural
SMALL PORTION OF MORTAR + LBM LEVELLING WALL. OVER SOL + MORTAR MIX (2635)			
Context same as:			

Finds: None <input checked="" type="checkbox"/> Pot <input type="checkbox"/> Bone <input type="checkbox"/> Glass <input type="checkbox"/> Metal <input type="checkbox"/> CBM <input type="checkbox"/> Flint <input type="checkbox"/> Wood <input type="checkbox"/> Leather <input type="checkbox"/>	
Other (specify):	
Sample No(s):	Drawing No(s): 2652 (X)
Photo No(s):	Sketch/levels overleaf: <input checked="" type="checkbox"/> Transferred to plan: <input checked="" type="checkbox"/>

Compiled by: BSS	Date: 23/2/15	Checked by: L.P.	Tick when entered in database: <input type="checkbox"/>
---------------------	------------------	---------------------	---

Context Number:
2652

Level No.s	Level No.s	Level No.s	Level No.s
TBM 11.80 11.50	TBM 0.03 0.03	TBM	TBM
B/S 11.83 11.53	IH	B/S	B/S
		IH	IH

No.	F/S	R/L (m OD)	No.	F/S	R/L (m OD)	No.	F/S	R/L (m OD)	No.	F/S	R/L (m OD)
1	1.82	9.95	(2)		9.65						
2	1.95	9.89			9.58						
3	1.95	9.89			9.58						

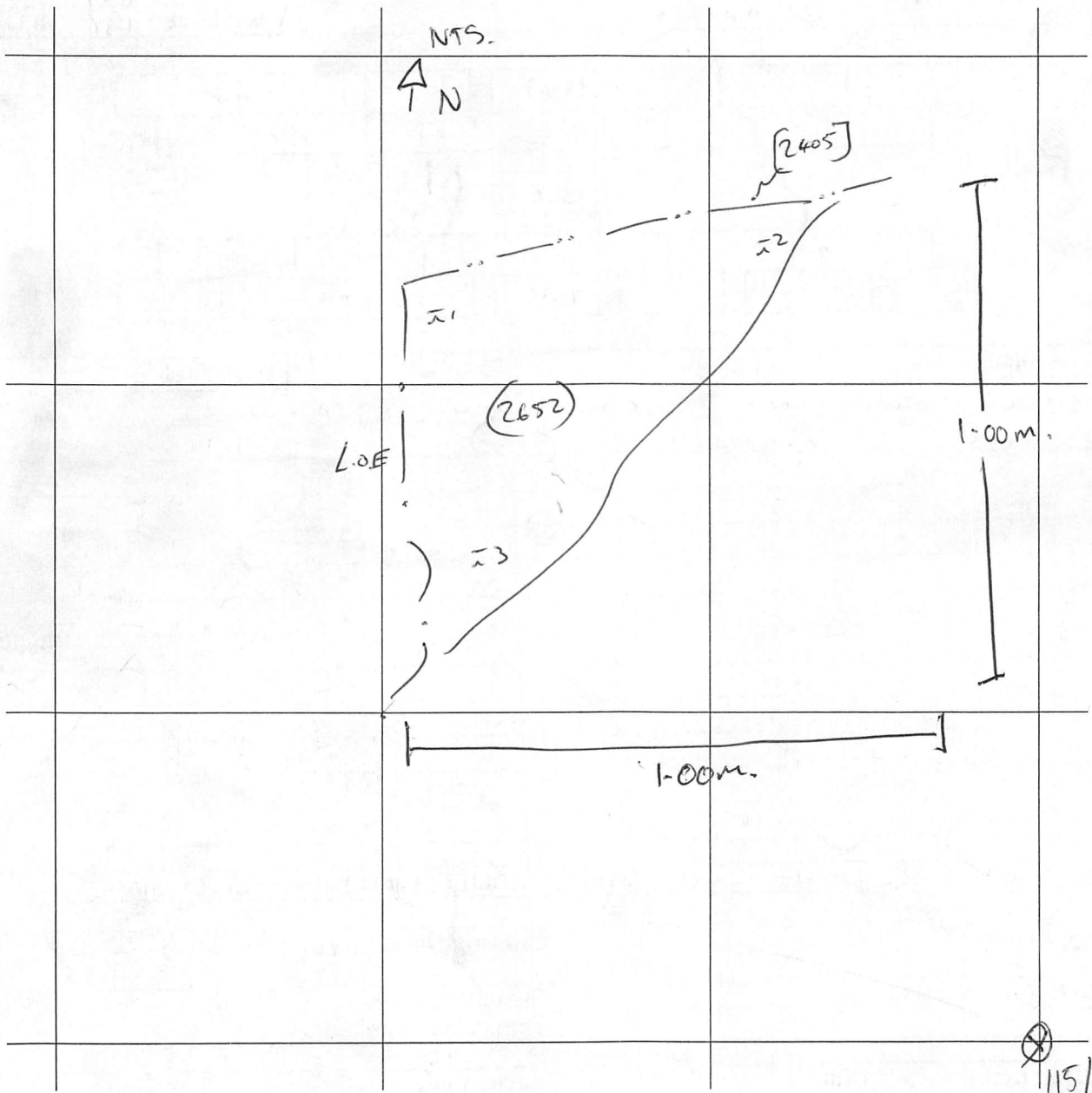

115/210