

Site Code: <b>MNOI2</b>	Location: AREA C	Grid Sq: 130/200 130/205 130/210	Context Type: DEPOSIT	Context Number: 3084
Deposit	① LOOSE ② LIGHT YELLOWISH BROWN ③ MEDIUM SAND ④ OCCA. WATER ERODED CBM 2-50mm, OCCA. SUB ROUNDED PEBBLES 30-70mm, occ. A-Bone, occ. Pot.			Cut 1. Shape in Plan 2. Corners 3. Dimensions 4. Break of slope - Top 5. Sides 6. Break of slope - Base 7. Base 8. Orientation 9. Inclination 10. Truncation 11. Other comments
1. Compaction				
2. Colour				
3. Composition				
4. Inclusions				
5. Interface				
6. Dimensions				
7. Other Comments				
8. Method/Conditions	Text			
5. Diffuse with (2865)				
6. 9.60(N-S) x 3.26m (At eastern temp. LOE)				
7. /				
8. Dry + hand dug (untracked)				Max Level: 8.16 m OD Min Level: 7.63 m OD

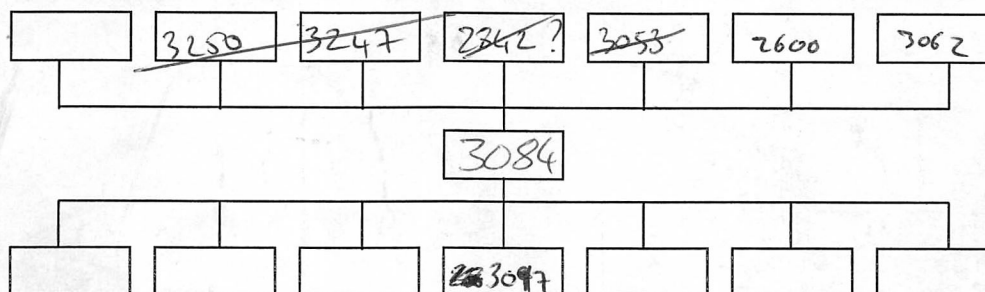

Interpretation:	Internal	External	<u>Structural</u>
DEPOSIT OF SAND TO THE EAST OF TIMBER REVETMENT [3097] TO BACKFILL THE REVETMENT			
Context same as:			

Finds: None <input type="checkbox"/> Pot <input checked="" type="checkbox"/> Bone <input checked="" type="checkbox"/> Glass <input type="checkbox"/> Metal <input type="checkbox"/> CBM <input checked="" type="checkbox"/> Flint <input type="checkbox"/> Wood <input type="checkbox"/> Leather <input type="checkbox"/>	
Other (specify):	
Sample No(s): —	Drawing No(s): 3084 (x3)
Photo No(s): —	Sketch/levels overleaf: <input checked="" type="checkbox"/> Transferred to plan: <input checked="" type="checkbox"/>

Compiled by: DB, JQ	Date: 22/04/15	Checked by: wsl/0/15	Tick when entered in database: <input type="checkbox"/>
------------------------	-------------------	-------------------------	---

Context Number:  
3084

Level No.s 1-35  
TBM 11.40  
B/S -0.27  
IH 11.13

Level No.s  
TBM  
B/S  
IH

Level No.s  
TBM  
B/S  
IH

Level No.s  
TBM  
B/S  
IH

No.	F/S	R/L (m OD)	No.	F/S	R/L (m OD)	No.	F/S	R/L (m OD)	No.	F/S	R/L (m OD)
1	3.34	7.74	6	2.99	8.14	11	3.02	8.11	16	3.09	8.04
2	2.97	8.16	7	3.07	8.06	12	3.07	8.06	17	3.46	7.67
3	3.07	8.06	8	3.06	8.07	13	3.48	7.65	18	3.07	8.06
4	3.10	8.03	9	3.49	7.64	14	3.11	8.02	19	3.04	8.09
5	3.44	7.64	10	3.01	8.12	15	3.09	8.04	20	3.05	8.08
21	3.41	7.72	22	3.04	8.09	23	3.14	7.99	24	3.04	8.09
25	3.49	7.64	26	3.29	7.84	27	3.06	8.07	28	3.07	8.06
29	3.50	7.63	30	3.28	7.85	31	3.19	7.94	32	3.40	7.75
33	3.43	7.70	34	3.24	7.89	35	3.12	8.01			

(4 PILE)

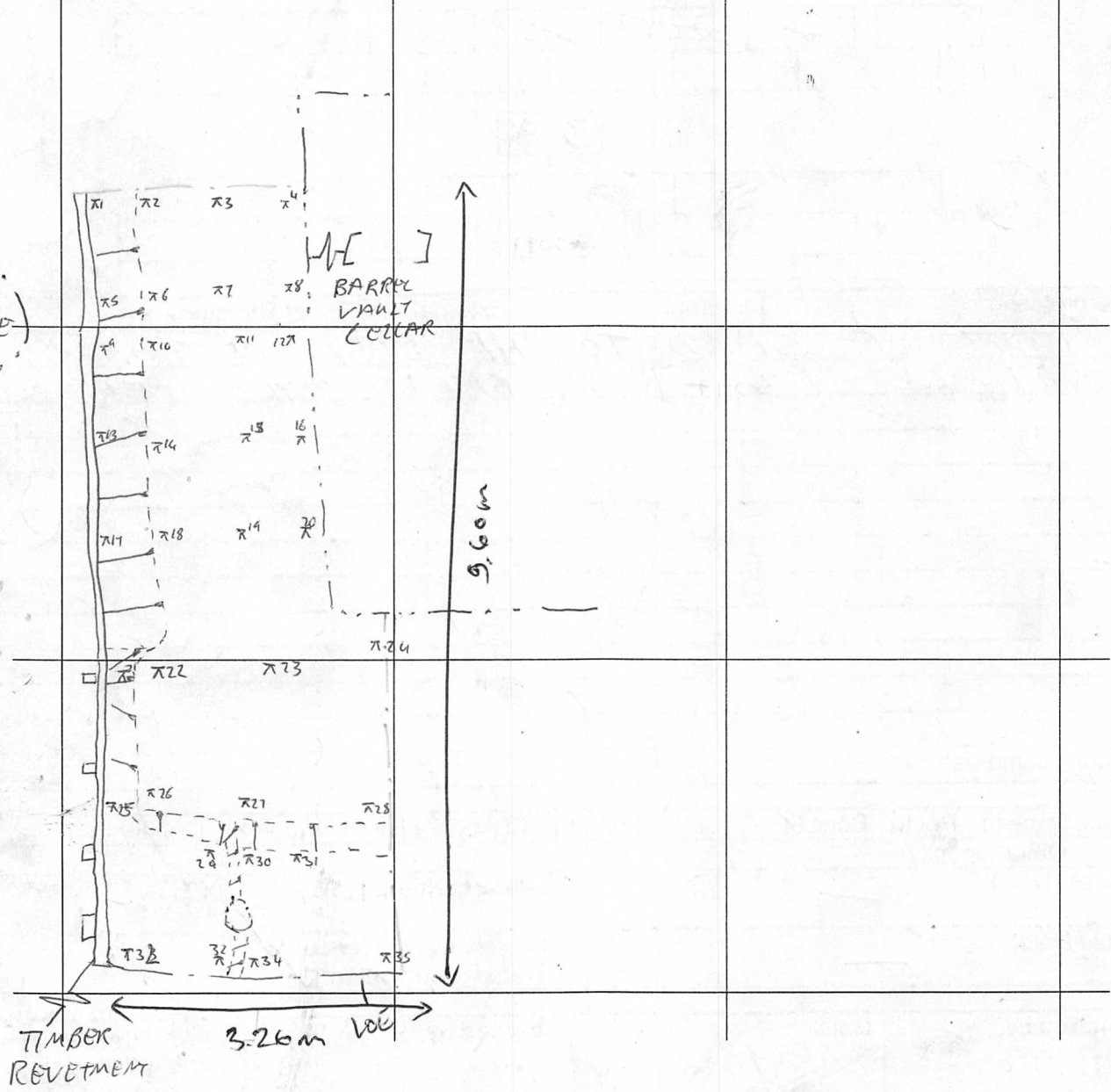

Sketch Plan & Notes