

| | | | | |
|---|--|--------------------------|--------------------------|---------------------------|
| Site Code: MNO12 | Location: AREA C | Grid Sq: 1351205-10 ? | Context Type: MASONRY | Context Number: [3005] |
| 1. Materials | 1. REDDY-ORANGE BRICK (POSS. SLIGHT FROG, HARD) | | | |
| 2. Size of materials (brick: BTL in mm) | 2. 103mm x 68mm x 220mm | | | |
| 3. Finish of stones | 3. MOUNDED BRICKS | | | |
| 4. Coursing / bond | 4. ENGLISH | | | |
| 5. Form | 5. FOUNDATION WALL WITH BOTTOM COURSE STRUVALINE | | | |
| 6. Direction of face(s) | 6. WEST | | | |
| 7. Surface treatment | 7. V. WORN / DAMAGED BY MODERN ACTIVITY | | | |
| 8. Bonding material (if brick: record height of 4 courses & 4 bed joints in m) | 8. MORTAR (WHITISH GREY, V. HARD, POSS. CHARCOX INCLUSIONS) 4 COURSES NOT PRESENT: APPROX MORTAR THICKNESS 10-20mm | | | |
| 9. Dimensions of masonry as found | 9. 1.72m N-S, 0.62m E-W HEIGHT 1.05m | | | |
| 10. Other comments | 10. RECORDED IN PLAN BY TS | | | |
| | 10. DRAIN CAVITY RUNNING DOWN CENTRE OF WALL 0.19m SQUARE | | Max Level: | m OD |
| | | | Min Level: | m OD |

Stratigraphic Relationships:

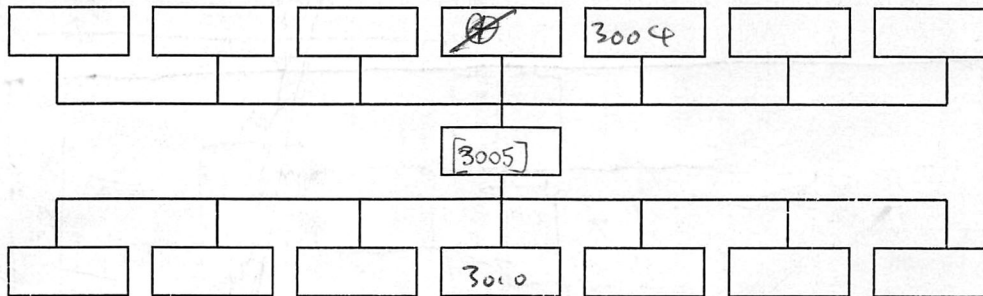

Physical Relationships:

| | |
|---------|--------------------|
| Abuts: | Abutted by: [3004] |
| Cut by: | |

| | | |
|--|----------|----------|
| Interpretation: | internal | external |
| Red brick wall | | |
| FRONT WALL OF 4 BUILDING FRONTING ONTO VINE STREET, GEORGIAN | | |
| IS ABUTTED BY [3004], BUT [3005]'S FOUNDATION IS APPROX. HALF A METRE DEEPER. APPEARS FAIRLY WELL CONSTRUCTED. | | |
| DRAIN CAVITY IN CENTRE OF WALL 0.19m SQUARE VERTICAL. | | |
| Context same as: | | |

| | |
|-----------------------|---|
| Sample No(s): 1 BRICK | Drawing No(s): (x) TS PLAN |
| Photo No(s): | Sketch/levels overleaf: <input type="checkbox"/> Transferred to plan: <input type="checkbox"/> |

| | | | |
|-----------------|----------------|--------------------|---|
| Compiled by: JG | Date: 14/04/15 | Checked by: s/ulis | Tick when entered in database: <input type="checkbox"/> |
|-----------------|----------------|--------------------|---|

Context Number:

[3005]

Level No.s recorded
TBM by
B/S total
IH station

Level No.s 1-6
TBM 11.40
B/S 0.54
IH 11.94

Level No.s
TBM
B/S
IH

Level No.s
TBM
B/S
IH

| No. | F/S | R/L (m OD) | No. | F/S | R/L (m OD) | No. | F/S | R/L (m OD) | No. | F/S | R/L (m OD) |
|--------------|-----------------|-----------------|--------------|-----------------|-----------------|-----|------|------------|-----|------|------------|
| 1 | 2.16 | 4.24 | 6 | 2.17 | 9.73 | 1 | 2.16 | 9.78 | 6 | 2.17 | 9.77 |
| 2 | 2.35 | 4.05 | | | | 2 | 2.35 | 9.59 | 7 | | |
| 3 | 2.24 | 9.16 | | | | 3 | 2.24 | 9.70 | | | |
| 4 | 2.35 | 9.05 | | | | 4 | 2.35 | 9.59 | | | |
| 5 | 2.25 | 9.15 | | | | 5 | 2.25 | 9.69 | | | |

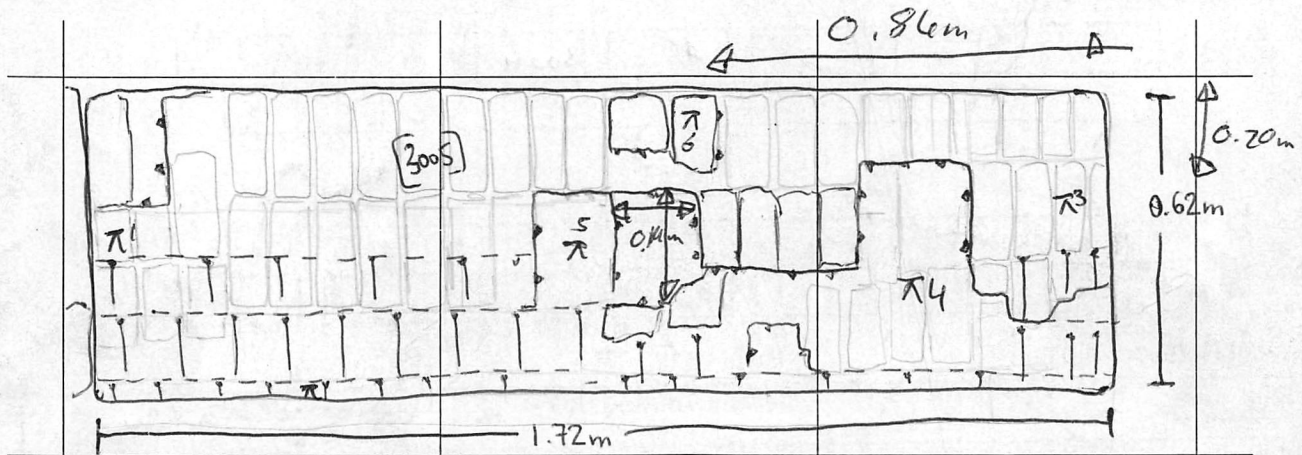

NTS

SEE [3004] FOR WEST FACING
PROFILE