

Site Code: MNO12	Location: C	Grid Sq: 145/210	Context Type: MASONRY	Context Number: 3491
1. Materials	1. RED BRICK			
2. Size of materials (brick: BTL in mm)	2. 110mm x 45mm x 220mm			
3. Finish of stones	3. MOULDED, UNFACED			
4. Coursing / bond	4. 3 COURSES IN 2 LINES OF STRETCHES & HALF BRICKS			
5. Form	5. WALL			
6. Direction of face(s)	6. UP			
7. Surface treatment	7. NONE			
8. Bonding material (if brick: record height of 4 courses & 4 bed joints in m)	8. WHITISH GREY SANDY MORTAR			
9. Dimensions of masonry as found	9. 0.98m N-S x 0.26m E-W, 0.20m height			
10. Other comments	10.			
				Max Level: 10.71 m OD
				Min Level: 10.62 m OD

Stratigraphic Relationships:

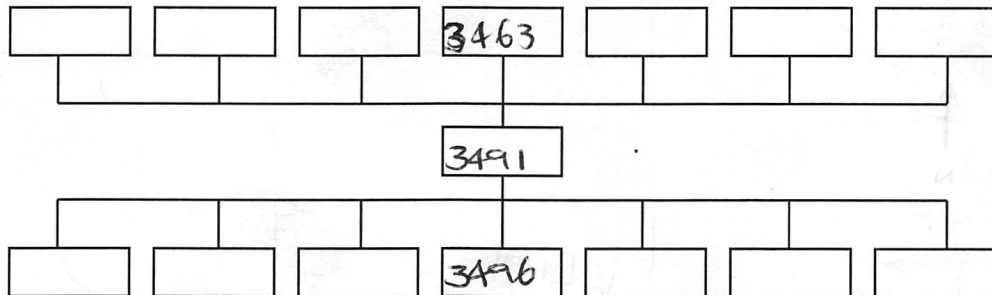

Physical Relationships:

Abuts: 3492	Abutted by:
Cut by: 3459, (+)	

Interpretation:	internal	<u>external</u>
BRICK WALL aligned N-S, TRUNCATED TO NORTH BY ROZZER cut [3459], CONTINUES FURTHER NORTH AS 3453 TRUNCATED		
TRUNCATED BY ROZZER CUT 3459		
Context same as: 5 3463 , 3496		

Sample No(s):	Drawing No(s): 3491 (x1)
Photo No(s):	Sketch/levels overleaf: <input type="checkbox"/> Transferred to plan: <input type="checkbox"/>

Compiled by: BC & TM	Date: 28/5/15	Checked by: a 11/10/15	Tick when entered in database: <input type="checkbox"/>
------------------------------------	-------------------------	----------------------------------	---

Context Number:
3491

Level No.s ~~1-2~~
TBM 11.40
B/S 1.17
IH 12.57

Level No.s 3
TBM 11.40
B/S 1.06
IH 12.46

Level No.s
TBM
B/S
IH

Level No.s
TBM
B/S
IH

No.	F/S	R/L (m OD)	No.	F/S	R/L (m OD)	No.	F/S	R/L (m OD)	No.	F/S	R/L (m OD)
1	1.86	10.71									
2	1.95	10.62									
3	1.80	10.66									

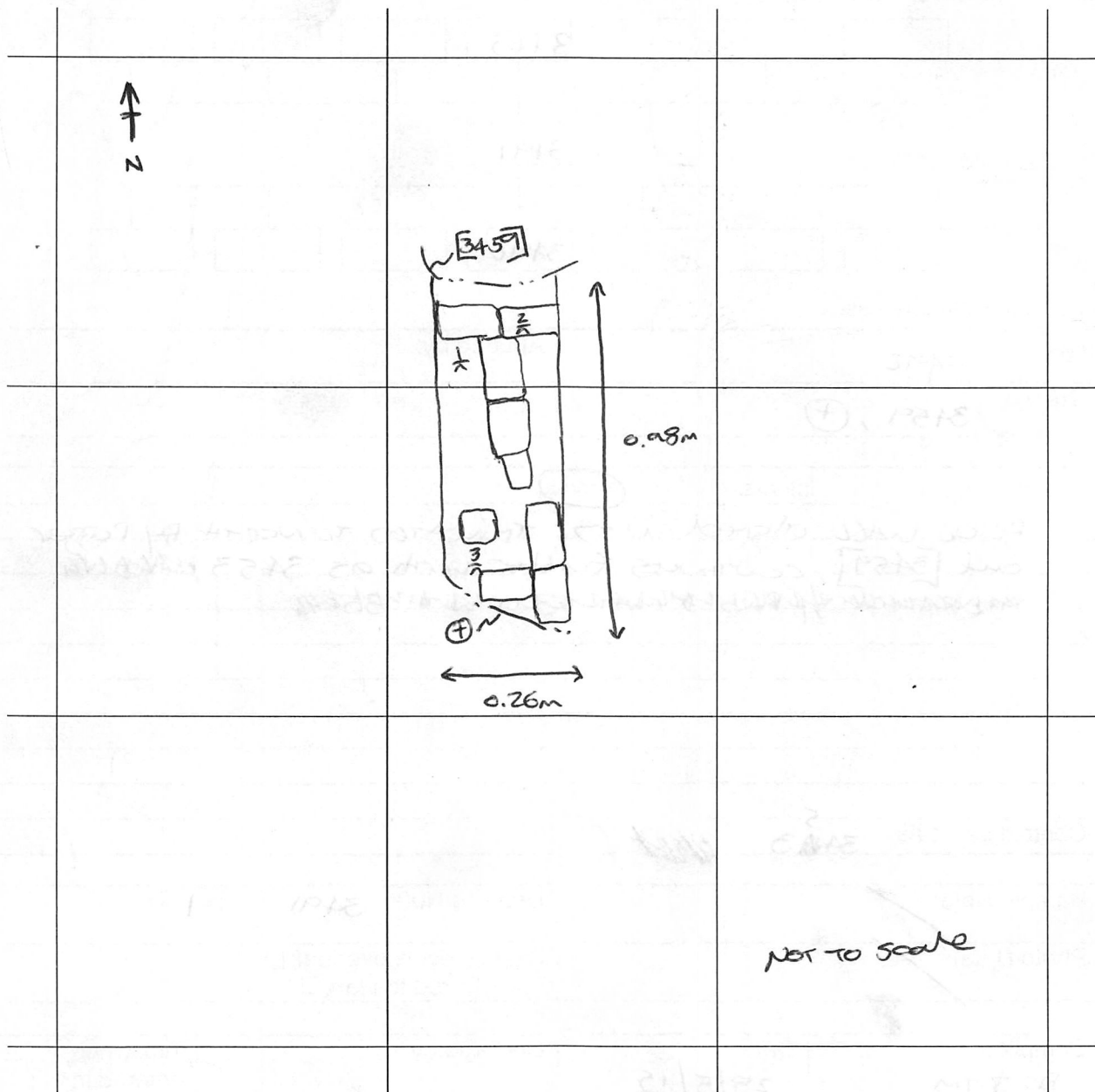

NOT TO SCALE