

| | | | | |
|---|---|------------------------------|--|-------------------------------------|
| Site Code: MNO12 | Location: D | Grid Sq: 150 / 230 | Context Type: MASONRY | Context Number: 4146 10F2 |
| 1. Materials | 1. MORTAR RED BRICKS + THICK CEMENT | | | |
| 2. Size of materials (brick: BTL in mm) | 2. 110 x 60 x 225 mm | | | |
| 3. Finish of stones | 3. MAULDED | | | |
| 4. Coursing / bond | 4. ? Important to be done ^{STRETCHER} Headers on BED → ENGLISH? | | | |
| 5. Form | 5. Excavation within wall ^{insertion of a} (4114) propose to install the tubular drain | | | |
| 6. Direction of face(s) | 6. UP - SOUTH. NORTH | | | |
| 7. Surface treatment | | | | |
| 8. Bonding material (if brick: record height of 4 courses & 4 bed joints in m) | 7. None. 8. Hard cement (white grey) with freq large (up to 10mm) lime and charcoal flecks + small rounded stones (5-10mm) + freq shells (Portland cement?) | | | |
| 9. Dimensions of masonry as found | 9. 1.94 x 0.58 (N-S) x 0.95 m (depth max) | | | |
| 10. Other comments | 10. cuts [4114] etc + [4202] | | Max Level: 10.81 m OD Min Level: 10.32 m OD | |

Stratigraphic Relationships:

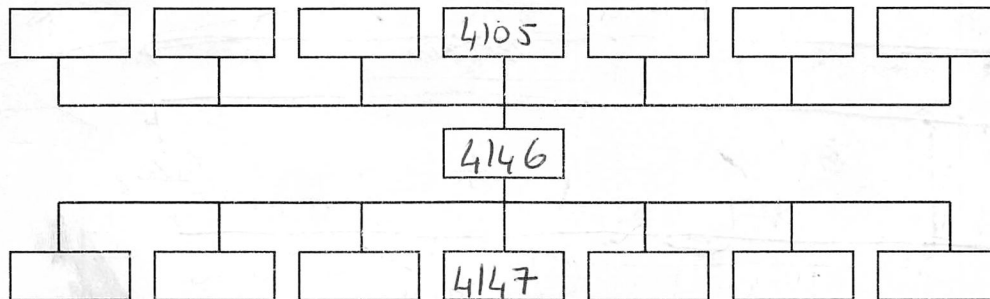

Physical Relationships:

| | |
|------------------------|----------------------|
| Abuts: — | Abutted by: — |
| Cut by: [41009] | |

| | | |
|--|----------|----------|
| Interpretation: | internal | external |
| <p>Excavation WALL Excavation Bricks and cement with inserted into wall [4114] and look like a "scar" in the wall. material used is very hard (almost impossible to mallet) material. It is a later change into the use of the cess pit [4114], ^{LINKED WITH} insertion of another wall running N-S inside the cess pit. A later deposit? A small section OF A TUBULAR DRAIN (RUNNING E-W) TOWARD TUBULAR DRAIN [4202]</p> | | |
| Context same as: | | |

| | |
|------------------------|---|
| Sample No(s): — | Drawing No(s): 4146 (x1) |
| Photo No(s): — | Sketch/levels overleaf: <input checked="" type="checkbox"/> Transferred to plan: <input checked="" type="checkbox"/> |

| | | | |
|---------------------------|---------------------------|------------------------------|---|
| Compiled by: Ac | Date: 30.6.2015 | Checked by: ac/ols | Tick when entered in database: <input type="checkbox"/> |
|---------------------------|---------------------------|------------------------------|---|

Context Number:
4146

Level No.s
TBM 11.40
B/S 0.68
IH 12.08 m od.

Level No.s 7 → 9
TBM
B/S
IH

Level No.s
TBM
B/S
IH

Level No.s
TBM
B/S
IH

| No. | F/S | R/L (m OD) | No. | F/S | R/L (m OD) | No. | F/S | R/L (m OD) | No. | F/S | R/L (m OD) |
|--------------|-----------------|------------------|-----|-----|------------|-----|-----|------------|-----|-----|------------|
| 1 | 1.32 | 10.76 | 4 | | | 9 | | | | | |
| 2 | 1.32 | 10.76 | 5 | | | | | | | | |
| 2 | 1.32 | 10.76 | 6 | | | | | | | | |
| 2 | | 10.81 | 7 | | | | | | | | |
| 3 | | 10.81 | 8 | | | | | | | | |

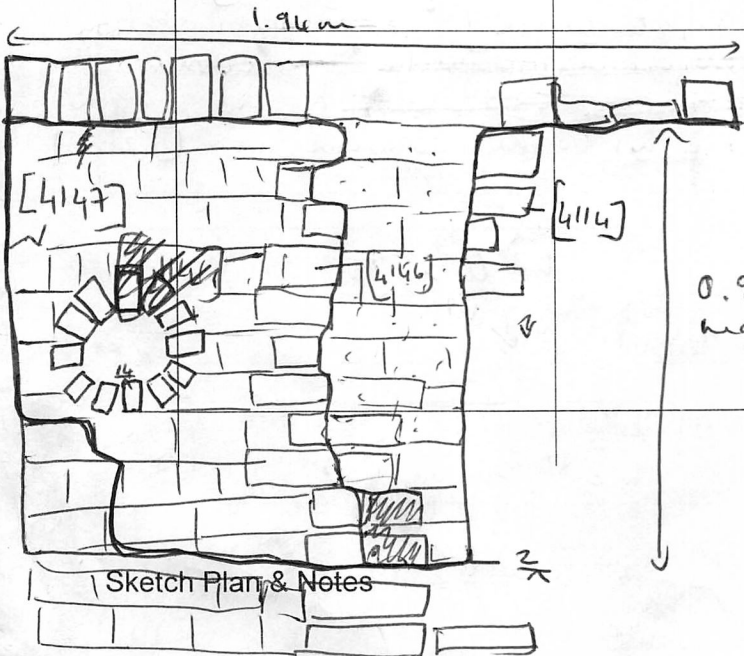
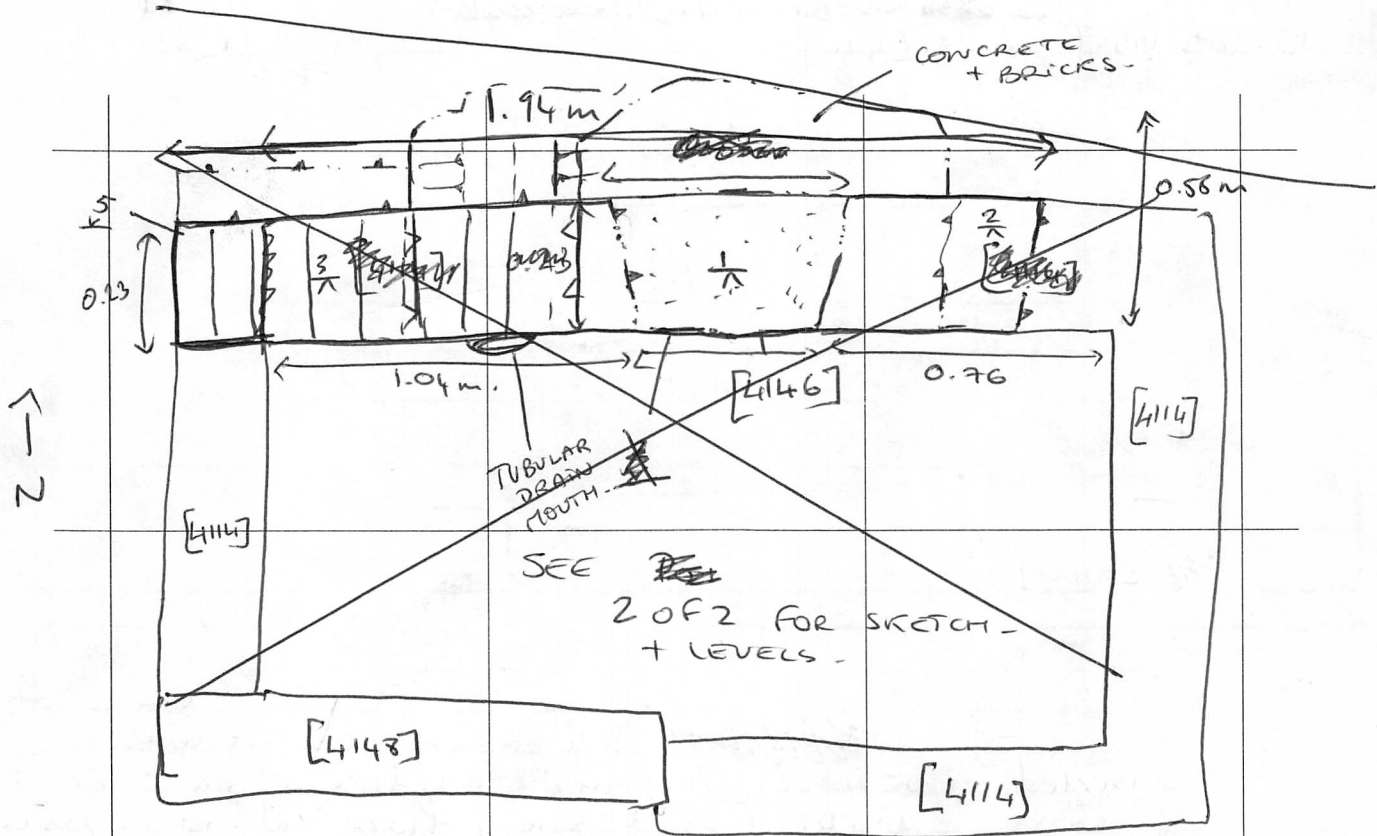

| | | | | |
|---|-----------------------|----------------------------|---------------------------------|------------------------------------|
| Site Code: MNO12 | Location: D | Grid Sq: 150/230 | Context Type: MASONRY | Context Number: 4146 2/2 |
| 1. Materials | | | | |
| 2. Size of materials (brick: BTL in mm) | | | | |
| 3. Finish of stones | | | | |
| 4. Coursing / bond | | | | |
| 5. Form | SEE 1 OF 2 | | | |
| 6. Direction of face(s) | | | | |
| 7. Surface treatment | | | | |
| 8. Bonding material (if brick: record height of 4 courses & 4 bed joints in m) | | | | |
| 9. Dimensions of masonry as found | | | | |
| 10. Other comments | | | | Max Level: m OD |
| | | | | Min Level: m OD |

Stratigraphic Relationships:

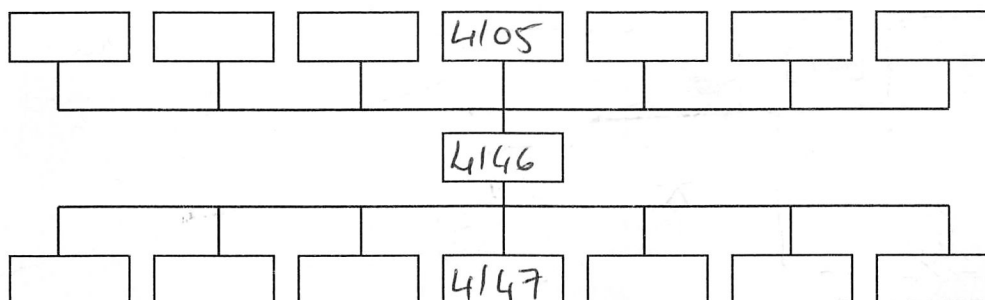

Physical Relationships:

| | |
|------------------|----------------------|
| Abuts: — | Abutted by: — |
| Cut by: — | |

| | | |
|-------------------|----------|----------|
| Interpretation: | internal | external |
| SEE 1 OF 2 | | |
| Context same as: | | |

| | |
|------------------------|---|
| Sample No(s): — | Drawing No(s): 4146 (x1) |
| Photo No(s): — | Sketch/levels overleaf: <input checked="" type="checkbox"/> Transferred to plan: <input checked="" type="checkbox"/> |

| | | | |
|---------------------------|---------------------------|--------------------------------|---|
| Compiled by: AC | Date: 30-6-2015 | Checked by: 27/06/15 | Tick when entered in database: <input type="checkbox"/> |
|---------------------------|---------------------------|--------------------------------|---|

Context Number:
4126

Level No.s 1 → 6
TBM 11.40
B/S 0.17
IH 12.37 mod.

Level No.s 7 → 9
TBM 11.40
B/S 0.74
IH 12.14 m

Level No.s
TBM
B/S
IH

Level No.s
TBM
B/S
IH 1.57

| No. | F/S | R/L (m OD) | No. | F/S | R/L (m OD) | No. | F/S | R/L (m OD) | No. | F/S | R/L (m OD) |
|--------------|------|------------|-----|------|------------|-----|-----------------|------------|-----|-----|------------|
| 4 | 1.76 | 10.61 | 7 | 1.58 | 10.56 | 1 | 1.32 | 10.76 | | | |
| 5 | 2.05 | 10.92 | 8 | 1.61 | 10.53 | 2 | 1.32 | 10.81 | | | |
| 6 | 2.12 | 10.25 | 9 | 1.70 | 10.47 | 3 | | 10.81 | | | → |
| 7 | | | | | | | | | | | |
| 8 | | | | | | | | | | | |

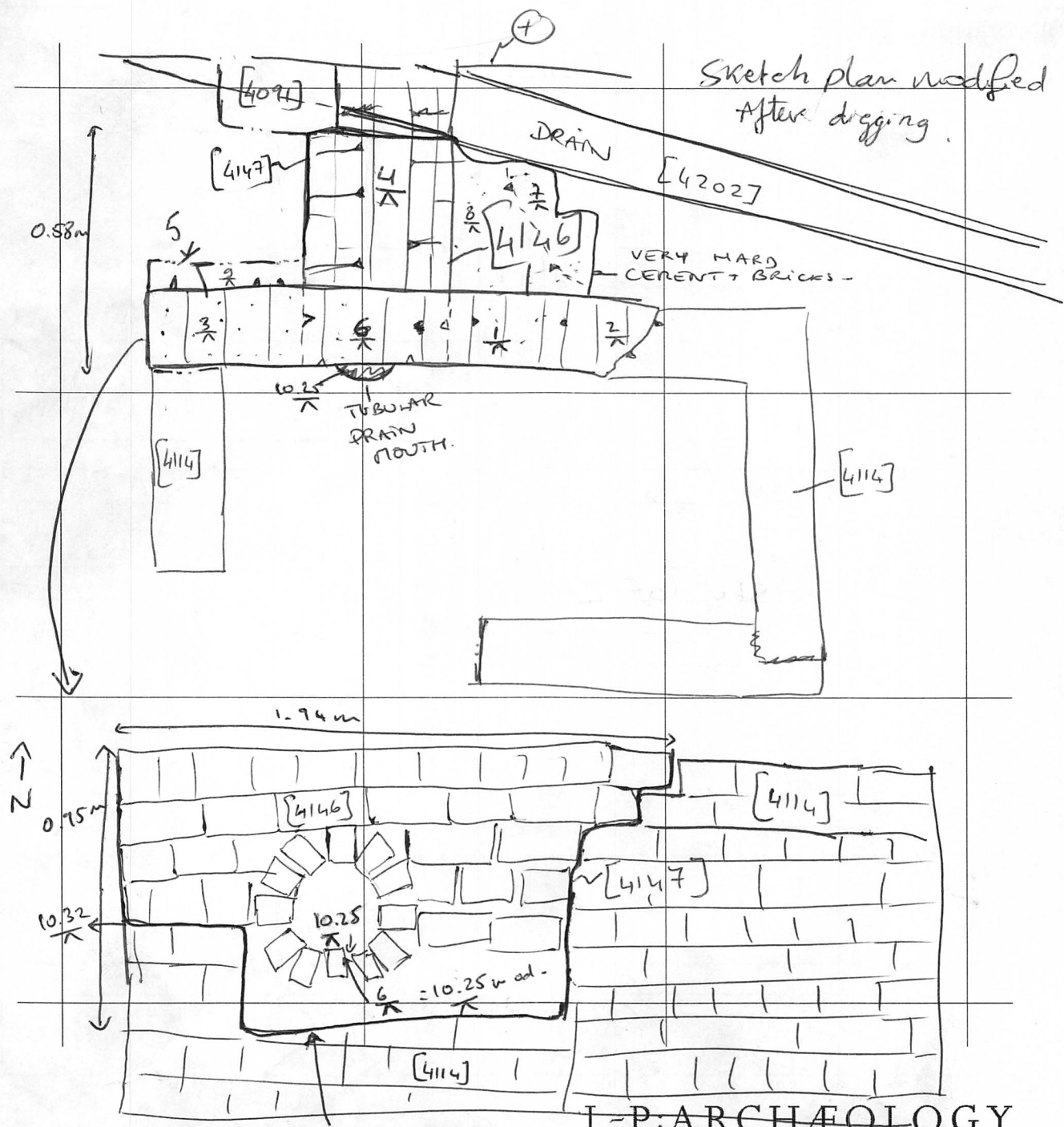

Sketch Plan & Notes

2.84 mod.