

Site Code: MNO12	Location: 9	Grid Sq: 145 / 230.	Context Type: MASONRY	Context Number: 4538.
1. Materials	① MID ORANGEY RED UNFROGGED BRICK			
2. Size of materials (brick: BTL in mm)	② 100 x 70 x 250			
3. Finish of stones	③ N/A.			
4. Coursing / bond	④ IRREGULAR.			
5. Form	⑤ LIGHTWELL			
6. Direction of face(s)	⑥ VERTICAL. N-S & E-W			
7. Surface treatment	⑦ WALL TILED INTERNAL FACE			
8. Bonding material (if brick: record height of 4 courses & 4 bed joints in m)	⑧ HEIGHT = 330mm - LIGHT GREYISH WHITE LIME MORTAR. SANDY MORTAR. OCC. CHARCOAL FLECKING ≤ 10mm.			
9. Dimensions of masonry as found	⑨ N-S 0.70m E-W 1.52m D 0.97m			
10. Other comments	⑩ -			
				Max Level: 12.46 m OD
				Min Level: 11.36 m OD

Stratigraphic Relationships:

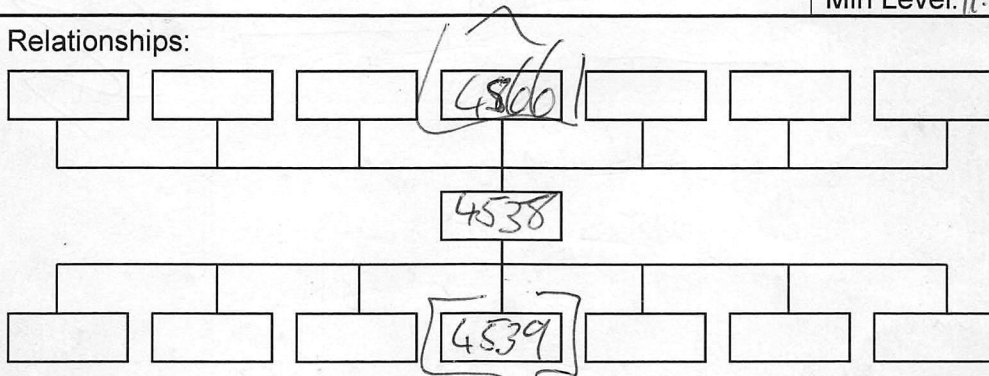

Physical Relationships:

Abuts: 4540	Abutted by: 4866
Cut by:	

Interpretation:	<input checked="" type="checkbox"/> internal	<input type="checkbox"/> external
LIGHTWELL FOR GEORGIAN BUILDING.		
OCCASIONAL YELLOW FIRE SKIN ON BRICKS.		
POORLY POINTED BONDING SEEPING OUT OF BEDDING JOINTS.		
ON OUTER FACE		
INNER FACE HAS TILES - WELL POINTED. TILES [4866]		
KEYED INTO WALL [4540] TO WEST EAST.		
Context same as:		

Sample No(s): BRICK	Drawing No(s): 4538 (x 1)
Photo No(s): 4866-69 <small>SAMPLG. 8815-20</small>	Sketch/levels overleaf: <input checked="" type="checkbox"/>
	Transferred to plan: <input checked="" type="checkbox"/>

Compiled by: JS	Date: 19/10/16.	Checked by: 24/10/16.	Tick when entered in database: <input type="checkbox"/>
------------------------	------------------------	------------------------------	---

Context Number:

4538

Level No.s 1-6
 TBM 1334-05
 B/S 1.58
 IH 14.92

Level No.s
 TBM
 B/S
 IH

Level No.s
 TBM
 B/S
 IH

Level No.s
 TBM
 B/S
 IH

No.	F/S	R/L (m OD)	No.	F/S	R/L (m OD)	No.	F/S	R/L (m OD)	No.	F/S	R/L (m OD)
1	2.46	12.46	6	2.52	12.40	11	2.90		16	2.91	
2	2.69	12.23	7	2.84		12	2.87		17	2.84	
3	2.46	12.46	8	3.12		13	2.90		18	2.44	
4	2.47	12.45	9	3.00		14	2.81		19	2.45	
5	2.50	12.42	10	2.91		15	2.82		20	3.07	

21 2.97
 22 3.06
 23 2.98
 24 3.10

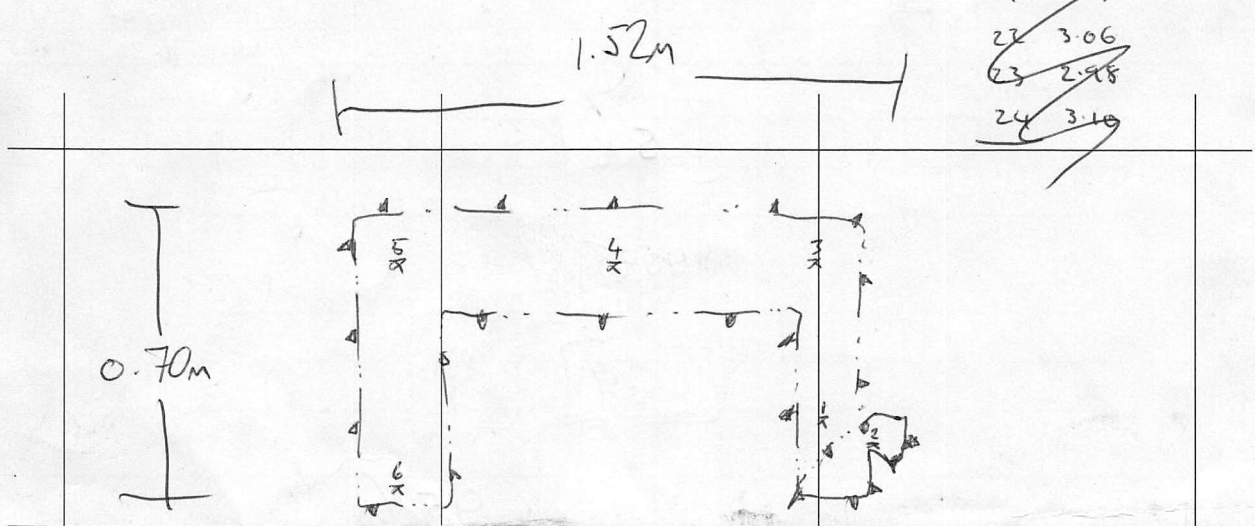

X-SECTION
 OF
 LIGHTWELL

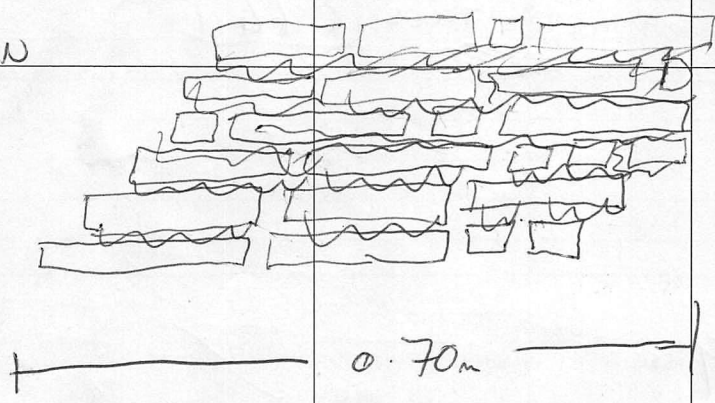

↑ N

NTS

0.97m

0.70m

→ N

NTS