

Site Code: MNO12	Grid Square: TP 2	Context Type: MASONRY	Context Number: 65
1. Materials	1 Red Brick → Purple Red Bricks		
2. Size of materials (brick: BTL in mm)	2 220 x 110 x 60 mm		
3. Finish of stones	3 UNFACED		
4. Coursing / bond	4 NUCLEAM. Row of SOLDIERS (HEADERS ON EDGE) AT BASE TO N.		
5. Form	5 WALL		
6. Direction of face(s)	6 WEST		
7. Bonding material (brick: Height of four courses & 4 bed joints in m)	7 HAND APPL. OVER MORTAR WITH CHINA + CHARCON INC.		
8. Dimensions of masonry as found	8 N-S: 1.80m x E-W: -0.88m		
9. Other comments	9 POSSIBLY TWO BUILDS / PHASES. VERTICALLY TRUNC. BY MODERN. S. EXTENT TRUNCATED / COLLAPSED INTO DRAIN (72) BUT APPEARS TO CONT. TO S. IN SECTION. WITHIN FOUNDATION CUT [64]		

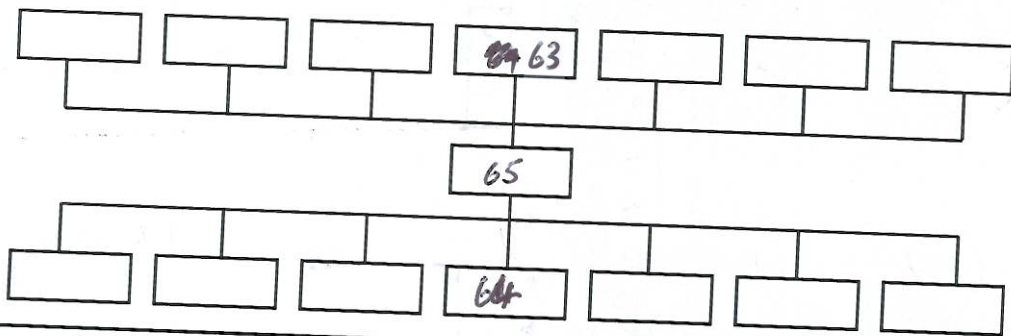

Interpretation:

N-S ORIENTATED BRICK WALL. VERTICAL TRUNCATION BY MODERN CONSTRUCTION MAKES INTERPRETATION DIFFICULT. TO SOUTH IT HAS COLLAPSED INTO DRAIN (72), BUT APPEARS TO CONT. TO SOUTH IN SECTION E-W ALIGNED 'BUTRESS' ON WEST SIDE HENCE WITH MONG APPEARS TO BE PART OF SAME BUILD, BUT SEAMS ALONG N+S FACES MUST AT POSSIBILITY OF SEPARATE BUILD. BRICK + MORTAR LOOK THE SAME AS MAIN WALL + COURSING APPEARS CONTINUOUS OVER THE TOP OF BOTH SECTIONS - ALTHOUGH VERTICALLY TRUNCATED. THINK FOUNDATION TRENCH [64] WAS DUG, REVERSE WALL [63] - WHICH WAS TRUNCATED. THE SMALL BUTRESS, WHICH

Context same as:

PTD

Sample No(s): /	Drawing No(s): p4 (x1)
Photo No(s): /	Sketch/levels overleaf: <input checked="" type="checkbox"/> Transferred to plan: <input checked="" type="checkbox"/>

Compiled by: PE	Date: 4.9.12	Checked by: an 21/9/12	Tick when entered in database: <input type="checkbox"/>
---------------------------	------------------------	----------------------------------	--

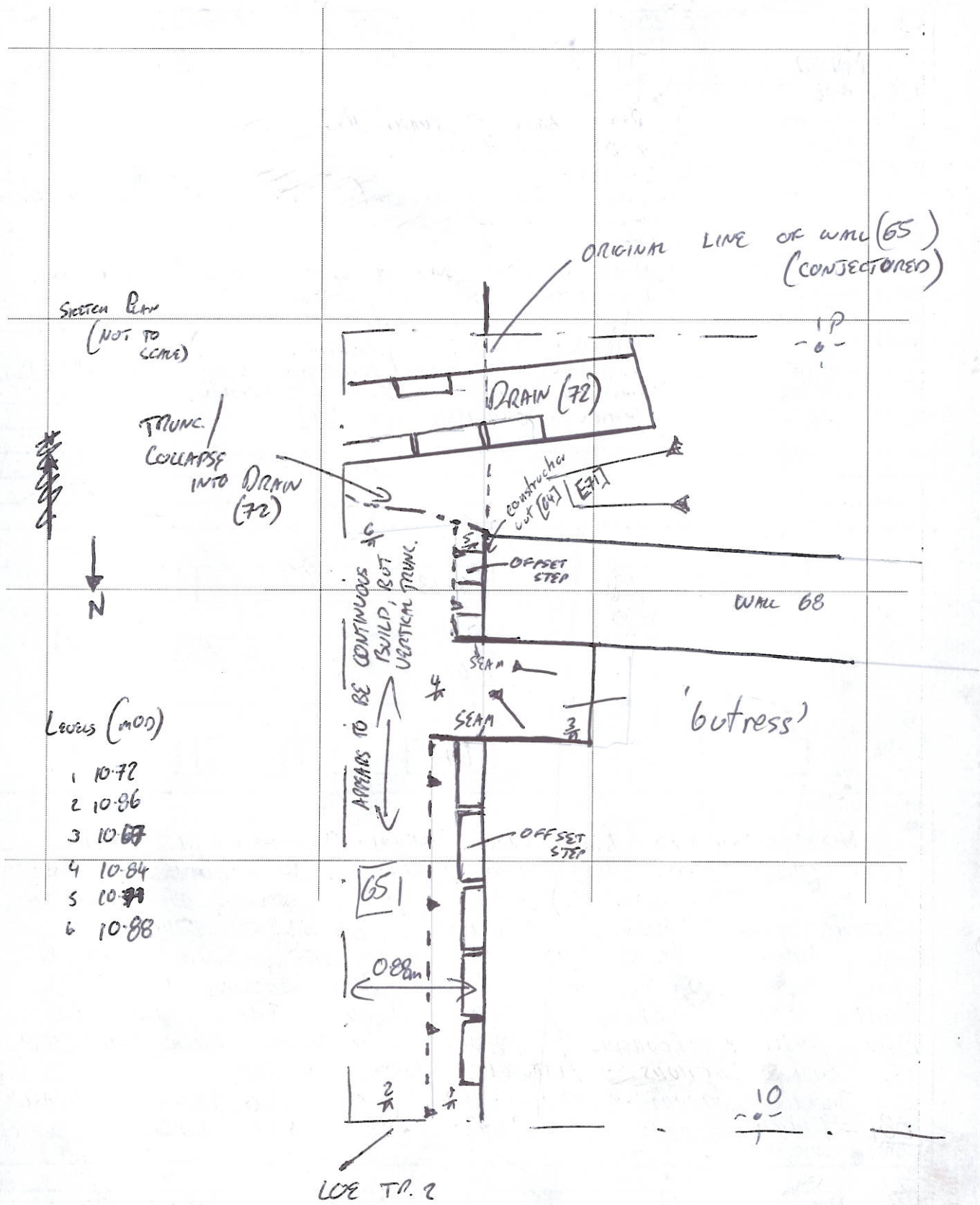

- Levels (MOD)
- 1 10-72
 - 2 10-86
 - 3 10-~~87~~
 - 4 10-84
 - 5 10-~~79~~
 - 6 10-88

IS AT LEAST 1 COURSE DEEPER, WAS BUILT AGAINST WALL 68 TO SHORE IT UP. THEN THE REST OF MS WALL (65) WAS BUILT, BRIDGED OVER DRAW (72).

DATE OF WALL UNCLEAR, COULD BE PART OF LATE (10th) CONSTRUCTION OF THE CRESENT, OR COULD BE EARLIER PHASE OF CONSTRUCTION