

Site Code: MNO12	Location: AREA A	Grid Sq: 145/ 145/260, 255	Context Type: CUT	Context Number: [1045]
Deposit				Cut
1. Compaction	1. <i>sub-rectangular</i>			1. Shape in Plan
2. Colour	2. <i>rounded</i>			2. Corners
3. Composition	3. <i>0.74m (length) x 0.62m (width) x 0.28m (d.)</i>			3. Dimensions
4. Inclusions	4. <i>sharp</i>			4. Break of slope – Top
5. Interface	5. <i>vertical</i>			5. Sides
6. Dimensions	6. <i>sharp</i>			6. Break of slope – Base
7. Other Comments	7. <i>flat</i>			7. Base
8. Method/Conditions	8. <i>N-S</i>			8. Orientation
	9. <i>N/A</i>			9. Inclination
FOR SOUTH SECTION:	10. <i>modern drain cut</i>			10. Truncation
② <i>SQUARED.</i>	11. <i>1</i>			11. Other comments
③ <i>1.24m (N-S) x 0.62m (E-W) x 0.38m (DEPTH).</i>				
⑩ <i>MODERN DRAIN CUT AND WALL ABUTTING DIRECTLY TO EAST.</i>				
①, ④-⑨, ⑪ <i>THE SAME TO ABOVE.</i>				
TD 03/12/14.				Max Level: <i>10.44</i> m OD
				Min Level: 10.12 <i>10.12</i> m OD

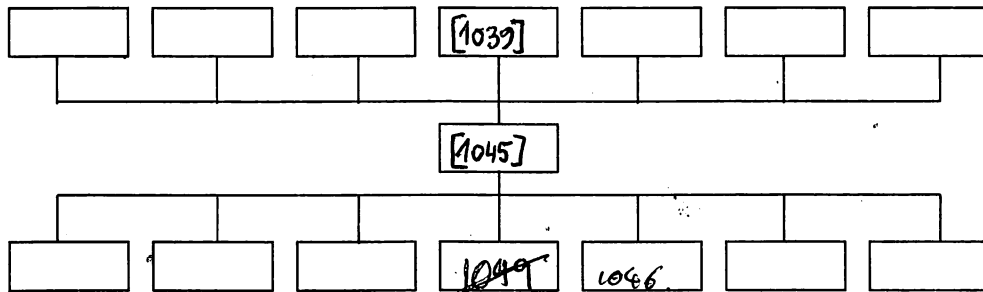

Interpretation:	internal	<u>External</u>	Structural
Wall cut of an 18 th c. building dating to 1760 and linked to the redevelopment of the Crescent.			
The cut was backfilled on the western side of the wall with (1044).			
The cut was truncated by a modern drain.			
Context same as: 2			

Finds: <input checked="" type="checkbox"/> None <input type="checkbox"/> Pot <input type="checkbox"/> Bone <input type="checkbox"/> Glass <input type="checkbox"/> Metal <input type="checkbox"/> CBM <input type="checkbox"/> Flint <input type="checkbox"/> Wood <input type="checkbox"/> Leather <input type="checkbox"/>	
Other (specify):	
Sample No(s): <i>/</i>	Drawing No(s): <i>1045 (x2)</i>
Photo No(s):	Sketch/levels overleaf: <input checked="" type="checkbox"/> Transferred to plan: <input checked="" type="checkbox"/>

Compiled by: <i>H.K.</i>	Date: <i>07/11/2014</i>	Checked by: <i>a 30/1/14</i>	Tick when entered in database: <input type="checkbox"/>
-----------------------------	----------------------------	---------------------------------	---

TD

03/12/14.

Context Number:
[1045]

Level No.s 1-3
TBM 10.57m
B/S 1.73m
IH 12.30m

Level No.s 4
TBM 10.57m
B/S 1.76m
IH 12.33m

Level No.s 5-6
TBM 10.29
B/S 1.90
IH 12.19

Level No.s
TBM
B/S
IH

No.	F/S	R/L (m OD)	No.	F/S	R/L (m OD)	No.	F/S	R/L (m OD)	No.	F/S	R/L (m OD)
1	2.44m	10.16m	4	2.17	10.16m						
2	1.93m	10.37m	5	2.07	10.17						
3	1.86m	10.44m	6	2.07	10.12						

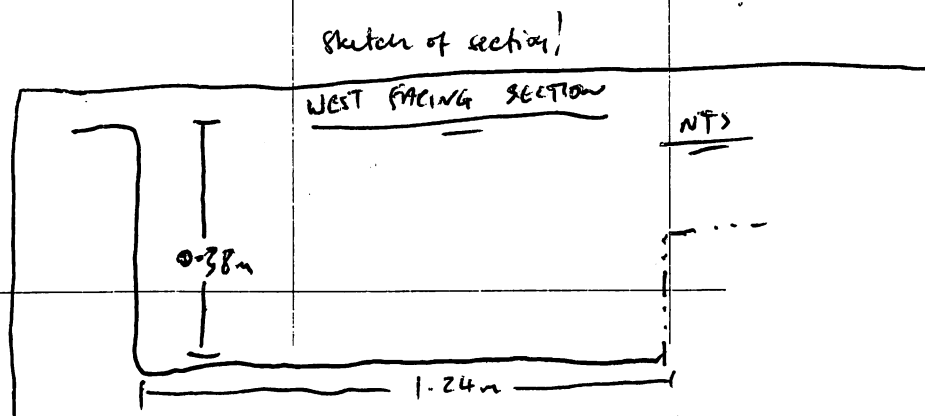
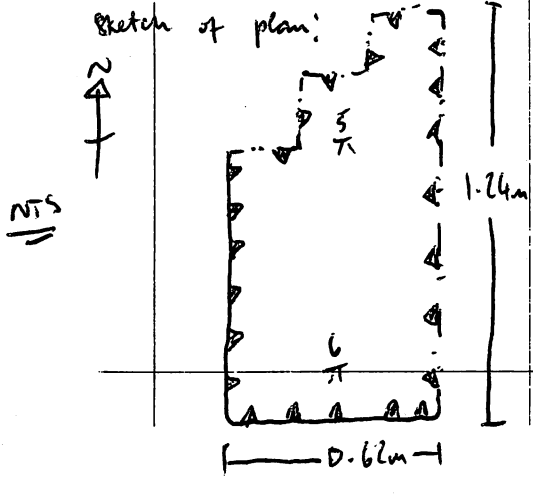
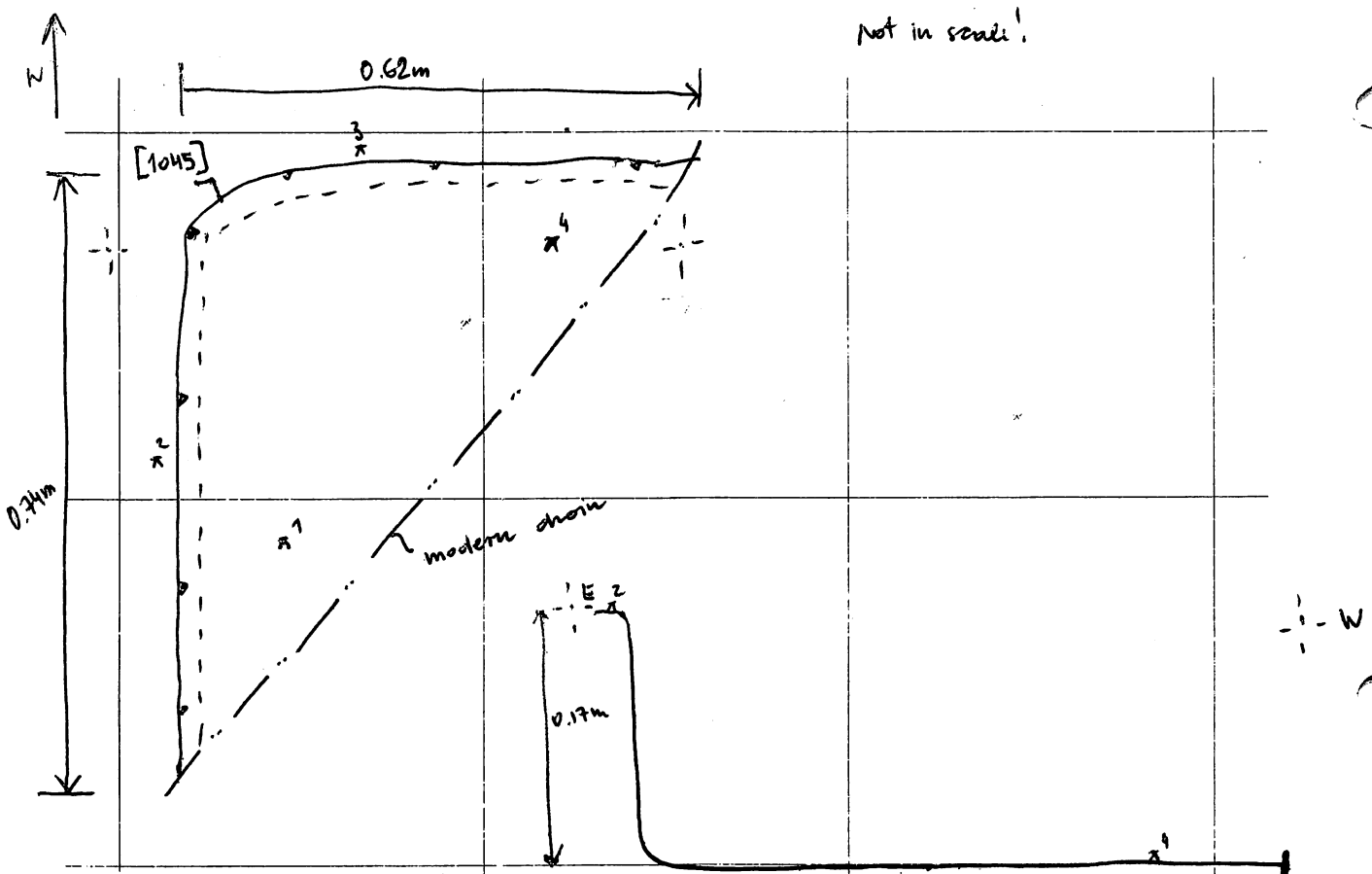

Sketch Plan & Notes