

Site Code: MNO12	Location: AREA B	Grid Sq: 115/205 - 210 110/205 - 210	Context Type: LAYER	Context Number: 2788
Deposit	1. Mod: mod > well compacted (gradient)			Cut
1. Compaction	2. Dark blackish brown Mid. dark brownish grey			1. Shape in Plan
2. Colour	3. Sandy silt w. lenses of compressed organic			2. Corners
3. Composition	'Stable-swinging'			3. Dimensions
4. Inclusions	4. Occur. Brick + tile frags, oyster shell,			4. Break of slope - Top
5. Interface	ca. bone, wood, sub-rounded stone 20-40mm			5. Sides
6. Dimensions	Occur mortar + chalk flecks, orange			6. Break of slope - Base
7. Other Comments	5. Poor to mod. layer above; good to			7. Base
8. Method/Conditions	Text layer below			8. Orientation
6. NS - 4.50m EW - 4.55m				9. Inclination
Depth				10. Truncation
7. Truncated by [2782] + [2787]				11. Other comments
8. Hand dug, methods + shovel/mort				
				Max Level: 6.78 m OD
				Min Level: 6.15 m OD

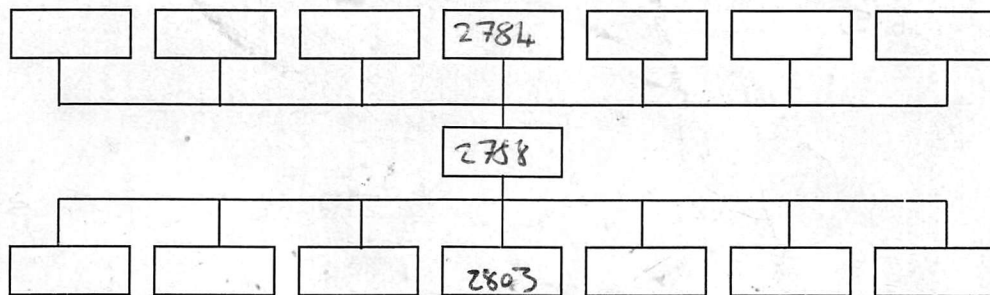

Interpretation:	<input type="checkbox"/> Internal	<input checked="" type="checkbox"/> External	<input type="checkbox"/> Structural
Ditch fill consisting of inter-layering lenses of compressed 'stable-swinging' organics + silty clump material; truncated by sub-rectangular trenches above prob. laid down in water-logged conditions, dis-use of ditch fill			
Context same as:			

Finds: None <input type="checkbox"/> Pot <input checked="" type="checkbox"/> Bone <input checked="" type="checkbox"/> Glass <input type="checkbox"/> Metal <input type="checkbox"/> CBM <input checked="" type="checkbox"/> Flint <input type="checkbox"/> Wood <input checked="" type="checkbox"/> Leather <input checked="" type="checkbox"/>	
Other (specify):	
Sample No(s): 151	Drawing No(s): 2788 (x4)
Photo No(s):	Sketch/levels overleaf: <input type="checkbox"/> Transferred to plan: <input type="checkbox"/>

Compiled by: CH + DB	Date: 25/03/15	Checked by: — 23/04/15	Tick when entered in database: <input type="checkbox"/>
-------------------------	-------------------	---------------------------	---

Context Number:
2788

Level No.s I -
TBM A.30
B/S
IH

Level No.s
TBM
B/S
IH

Level No.s
TBM
B/S
IH

Level No.s
TBM
B/S
IH

No.	F/S	R/L (m OD)	No.	F/S	R/L (m OD)	No.	F/S	R/L (m OD)	No.	F/S	R/L (m OD)
1		6.45	6		6.70	11		6.50	16		6.74
2		6.59	7		6.51	12		6.51	17		6.78
3		5.77	8		6.69	13		6.15	18		6.54
4		6.53	9		6.58	14		6.29	19		6.54
5		6.59	10		6.57	15		6.19	20		6.55

21
22
23
24
25
26

WBA

6.51
6.55
6.52
6.34
6.32
6.50

NOT TO SCALE

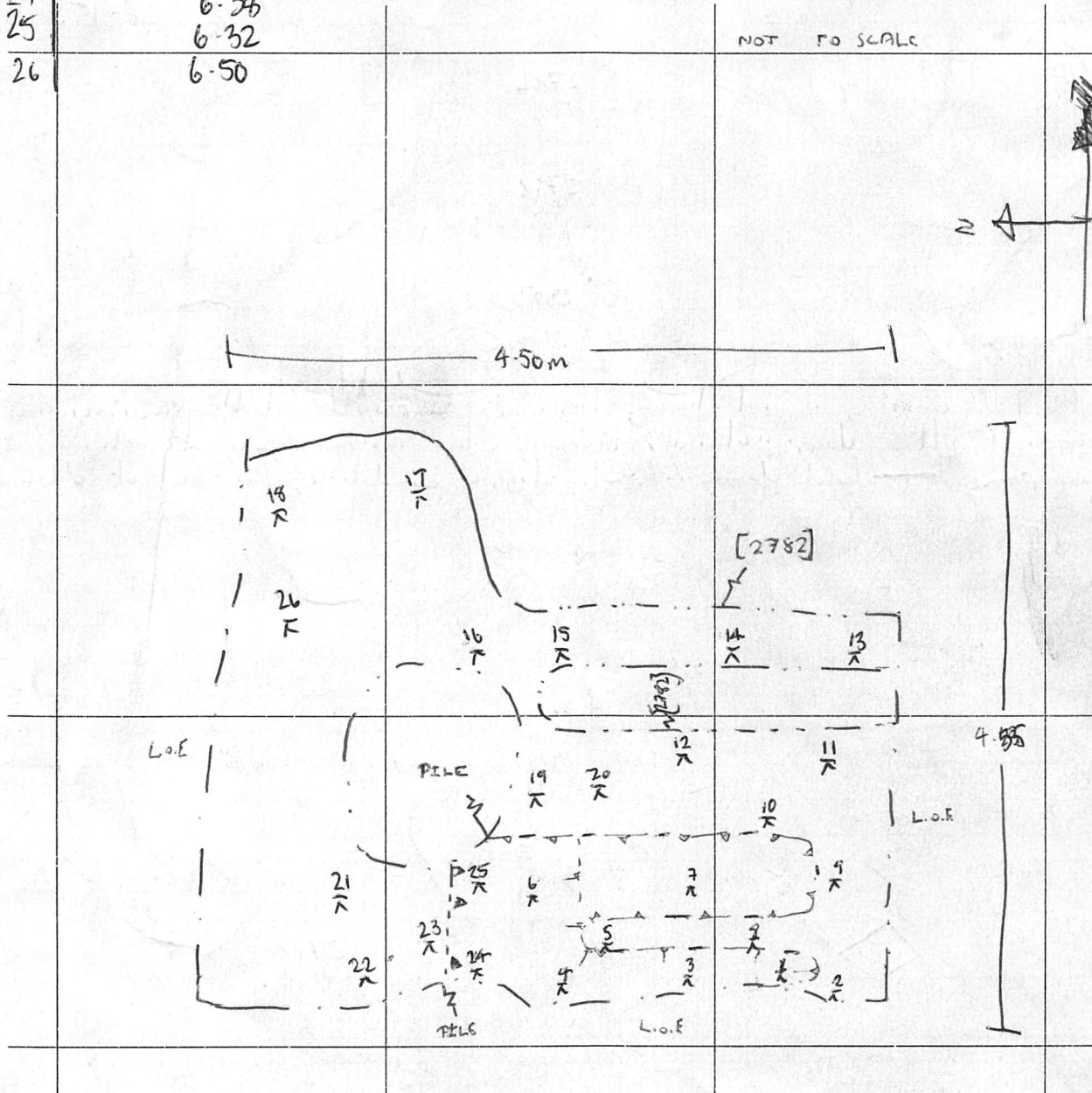
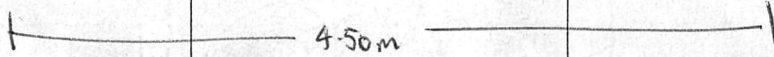
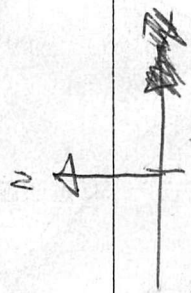

N - 2.90
1.60

E 2.25
2.10