



Context Number:

26835

Level No.s

TBM 11.80 11.50

B/S 0.09 0.09

IH 11.89 11.59

Level No.s

TBM

B/S

IH

Level No.s

TBM

B/S

IH

Level No.s

TBM

B/S

IH

No.	F/S	R/L (m OD)	No.	F/S	R/L (m OD)	No.	F/S	R/L (m OD)	No.	F/S	R/L (m OD)
1	1.90	9.99	②	<del>1.90</del>	9.69						
2	1.85	10.04		<del>1.85</del>	9.74						
3	1.97	9.92			9.62						
4	1.87	10.02			9.72						

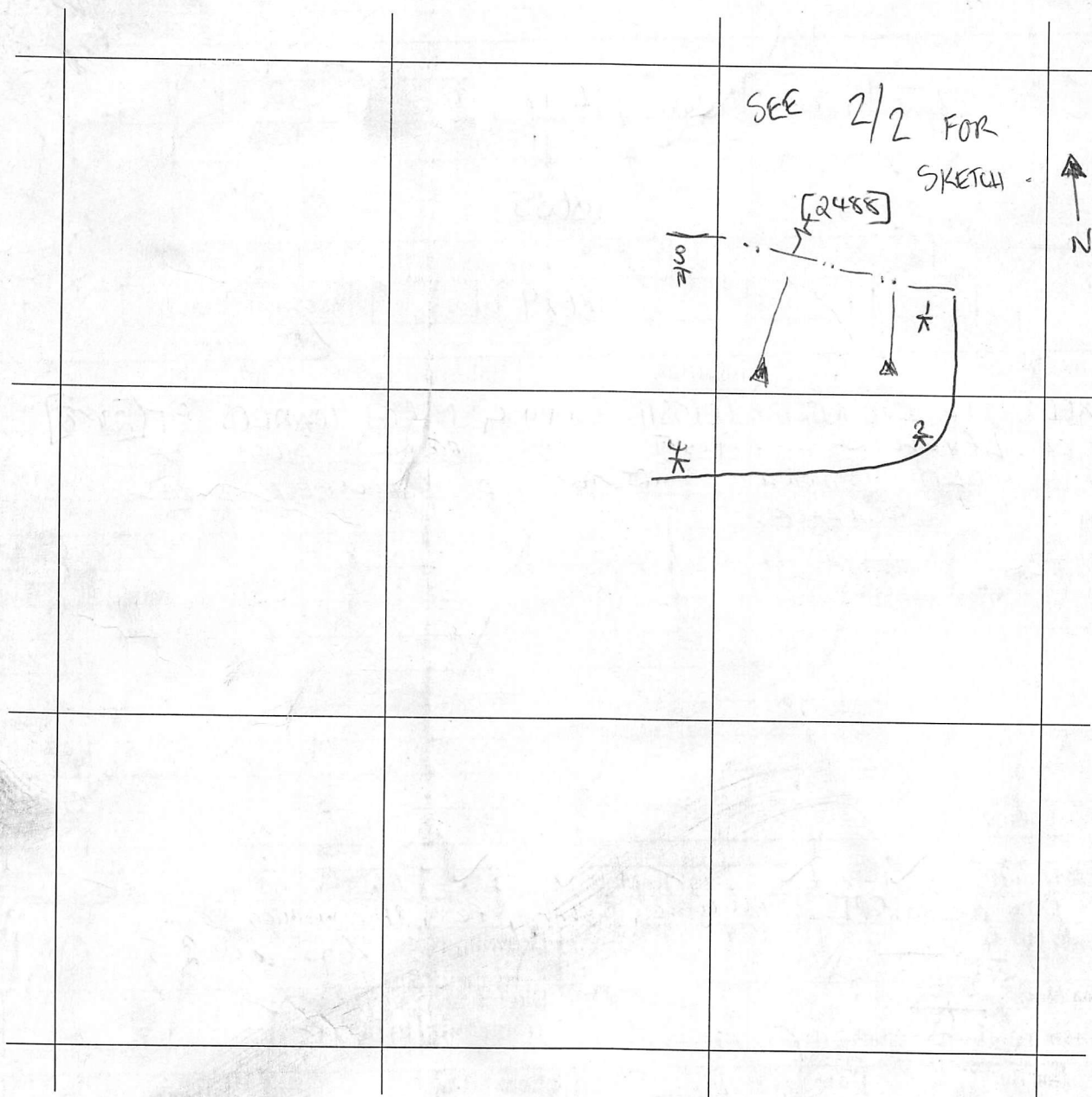

Site Code: <b>MNO12</b>	Location: B	Grid Sq: 110/205 110/210 115/205 115/210	Context Type: DEPOSIT	Context Number: 2635
Deposit 1. Compaction 2. Colour 3. Composition 4. Inclusions 5. Interface 6. Dimensions 7. Other Comments 8. Method/Conditions	SEE SHEET #1			Cut 1. Shape in Plan 2. Corners 3. Dimensions 4. Break of slope - Top 5. Sides 6. Break of slope - Base 7. Base 8. Orientation 9. Inclination 10. Truncation 11. Other comments
Text				
				Max Level: m OD
				Min Level: m OD

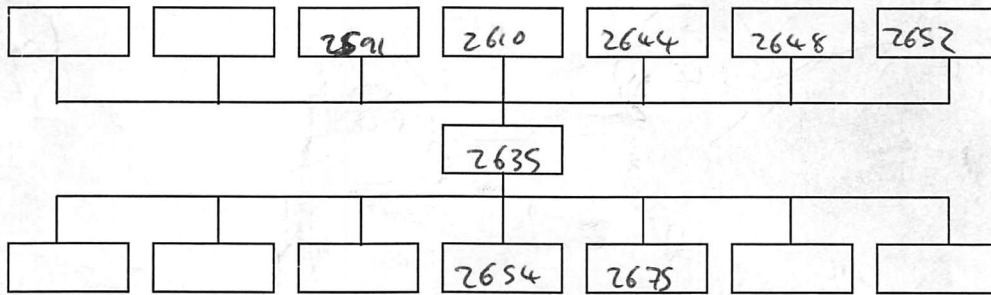

Interpretation:	Internal	External	Structural
SEE SHEET #1			
Context same as:			

Finds: None <input type="checkbox"/> Pot <input type="checkbox"/> Bone <input type="checkbox"/> Glass <input type="checkbox"/> Metal <input type="checkbox"/> CBM <input type="checkbox"/> Flint <input type="checkbox"/> Wood <input type="checkbox"/> Leather <input type="checkbox"/>	
Other (specify):	
Sample No(s):	Drawing No(s): 2635 (x5)
Photo No(s):	Sketch/levels overleaf: <input type="checkbox"/> Transferred to plan: <input type="checkbox"/>

Compiled by:	Date:	Checked by: L.Hol.S	Tick when entered in database: <input type="checkbox"/>
--------------	-------	------------------------	---

Context Number:  
2635 20F2

Level No.s 1 - 16.19	Level No.s	Level No.s	Level No.s
TBM 11.80 11.50	TBM	TBM	TBM
B/S 0.03 0.03	B/S	B/S	B/S
IH 11.83 11.53	IH	IH	IH

No.	F/S	R/L (m OD)	No.	F/S	R/L (m OD)	No.	F/S	R/L (m OD)	No.	F/S	R/L (m OD)
1	2.00	9.83	6	1.88	9.95	11	2.45	9.33	16	1.92	9.91
2	2.00	9.83	7	1.94	9.89	12	1.99	9.84	17	2.06	9.77
3	1.90	9.93	8	1.93	9.70	13	1.84	9.99	18	2.04	9.79
4	1.86	9.97	9	2.05	9.78	14	1.98	9.95	19	1.99	9.84
5	1.89	9.94	10	2.38	9.45	15	2.27	9.56			

A ~ .

