

Site Code: MNO12	Location: B	Grid Sq: 125/205 125/210	Context Type: LAYER	Context Number: 2855
Deposit	1. Compact			Cut
1. Compaction	2. mid brown greyish			1. Shape in Plan
2. Colour	3. Silty clay			2. Corners
3. Composition	4. occ. pots, cbm leather			3. Dimensions
4. Inclusions	A. Bone . occ. to frequent			4. Break of slope - Top
5. Interface	oyster shells and seeds			5. Sides
6. Dimensions	occ. lime flakes flecks -			6. Break of slope - Base
7. Other Comments	occ. small rounded + angular			7. Base
8. Method/Conditions	Text stones (including flint)			8. Orientation
	5. well defined			9. Inclination
	6-2.66 to 3.00m (E-W) x 5m (N-S)			10. Truncation
	7. ✓			11. Other comments
	8. hand dug, dry conditions-			
				Max Level: 700 m OD
				Min Level: 6.43 m OD

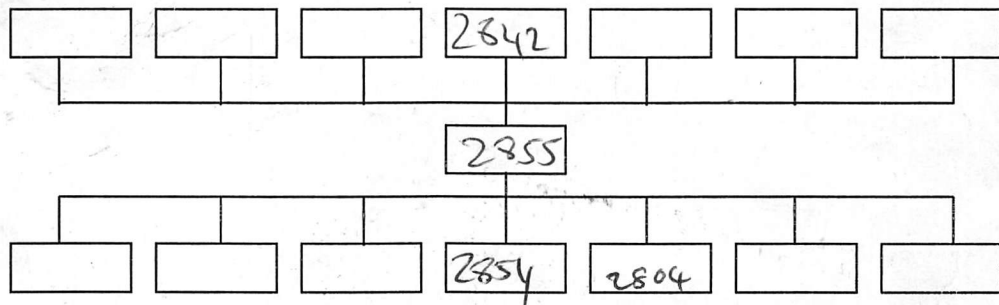

Interpretation:	Internal	External	Structural
Brown SILTY LAYER UNDERNEATH (2842)			
Context same as:			

Finds: None <input type="checkbox"/> Pot <input type="checkbox"/> Bone <input checked="" type="checkbox"/> Glass <input type="checkbox"/> Metal <input type="checkbox"/> CBM <input checked="" type="checkbox"/> Flint <input type="checkbox"/> Wood <input type="checkbox"/> Leather <input checked="" type="checkbox"/>	
Other (specify):	
Sample No(s): <210> vol	Drawing No(s): (x)
Photo No(s):	Sketch/levels overleaf: <input checked="" type="checkbox"/> Transferred to plan: <input checked="" type="checkbox"/>

Compiled by: AC	Date: 22-04-2015	Checked by: ~27/04/15	Tick when entered in database: <input type="checkbox"/>
---------------------------	----------------------------	---------------------------------	---

Context Number:

2855

Level No.s

TBM 11.40

B/S -0.28

IH 11.12

Level No.s

TBM

B/S

IH

Level No.s

TBM

B/S

IH

Level No.s

TBM

B/S

IH

No.	F/S	R/L (m OD)	No.	F/S	R/L (m OD)	No.	F/S	R/L (m OD)	No.	F/S	R/L (m OD)
1	4.58	6.54	6	4.12	7.00	11	4.65	6.47			
2	4.28	6.84	7	4.34	6.78						
3	4.43	6.69	8	4.51	6.61						
4	4.34	6.78	9	4.69	6.43						
5	4.36	6.76	10	4.62	6.50						

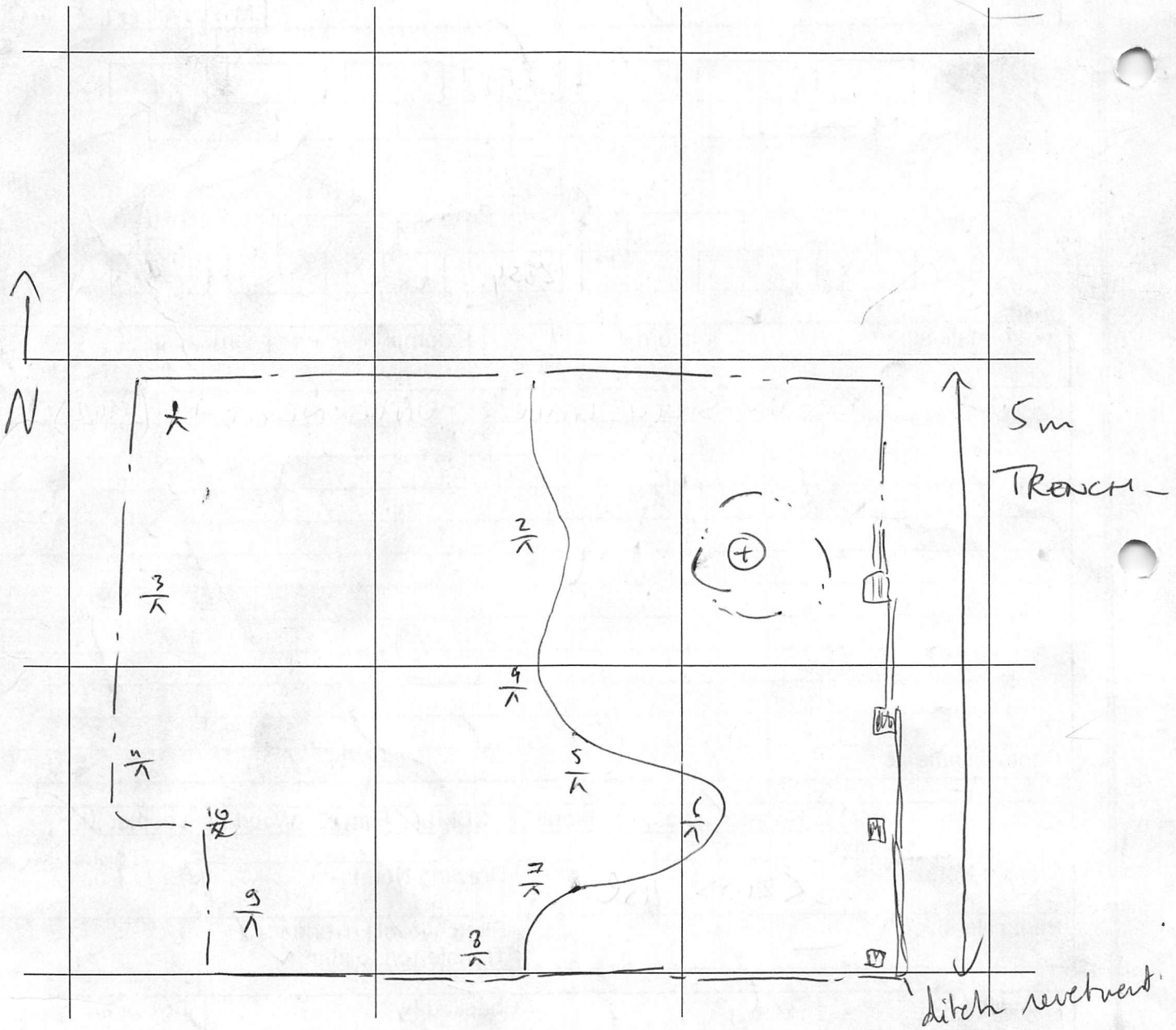

L-P:ARCHAEOLOGY

Sketch Plan & Notes