

Site Code: MNO12	Location: B	Grid Sq: 125-130/200	Context Type: MASONRY	Context Number: 2381 1043
1. Materials	1. Soft hand made bricks			
2. Size of materials (brick: BTL in mm)	2. 190 190 x 69 x 230 mm			
3. Finish of stones	3. English bond			
4. Coursing / bond	4. Bonds wall			
5. Form	5. East facing South face			
6. Direction of face(s)	6. N/A			
7. Surface treatment	7. 16 courses: 1.22 m <small>SPAT MID GRAY LIME MORTAR, OCCAS</small>			
8. Bonding material (if brick: record height of 4 courses & 4 bed joints in m)	8. 1.22 mod 16 courses; dark yellowish grey limestone inclusions <small>ANNOUAT</small>			
9. Dimensions of masonry as found	9. N/S - 2.06 mod F.W. 5.90 mod <small>LIME FLINTS</small>			
10. Other comments	Depth: 1.22 mod 0.24 ~ 0.105			
				Max Level: 10.43 10.43 m OD
				Min Level: 9.58 m OD

Stratigraphic Relationships:

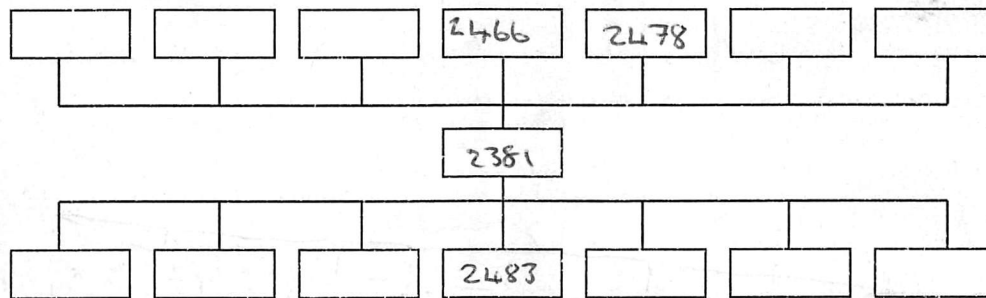

Physical Relationships:

Abuts:	Abutted by:
Cut by:	

Interpretation:	internal	<u>external</u>
BACK FILL OF VINE STAKE CONCRETE		
CONCRETE WALL at South Eastern end of area B; Exposed to the East by drain [2386]; disjunct to the North in the centre by rubble cut [2484]		
WALL WAS COLLAPSING / DEMOLISHED ON N. SIDE BUT BRICKS CLEANED OUT FOR RE-USE PRIOR TO INFILL OF COURSE		
Context same as:		

Sample No(s):	2 x BRICK	Drawing No(s):	2381 (x 2)
Photo No(s):	✓	Sketch/levels overleaf:	<input checked="" type="checkbox"/>
		Transferred to plan:	<input type="checkbox"/>

Compiled by:	Date:	Checked by:	Tick when entered in database:
CM	21/1/15	on 8/2/15	<input type="checkbox"/>

Context Number:
2666 2381

Level No.s 1-12
TBM 11.80 11.50
B/S 1.18
IH 12.28 12.68

Level No.s
TBM
B/S
IH

Level No.s
TBM
B/S
IH

Level No.s
TBM
B/S
IH

No.	F/S	R/L (m OD)	No.	F/S	R/L (m OD)	No.	F/S	R/L (m OD)	No.	F/S	R/L (m OD)
1	3.10	9.88	6	2.95	10.07	11	3.43	9.35			
2	3.35	9.63	7	2.73	10.25	12	2.25	10.73			
3	2.85	10.13	8	2.67	10.71						
4	3.43	9.55	9	2.59	10.41						
5	2.96	10.02	10	3.57	9.41						

1 9.58
 2 9.33
 3 9.83
 4 9.25
 5 9.72
 6 9.73
 7 9.95
 8 10.01
 9 10.10
 10 9.11
 11 9.05
 12 10.43

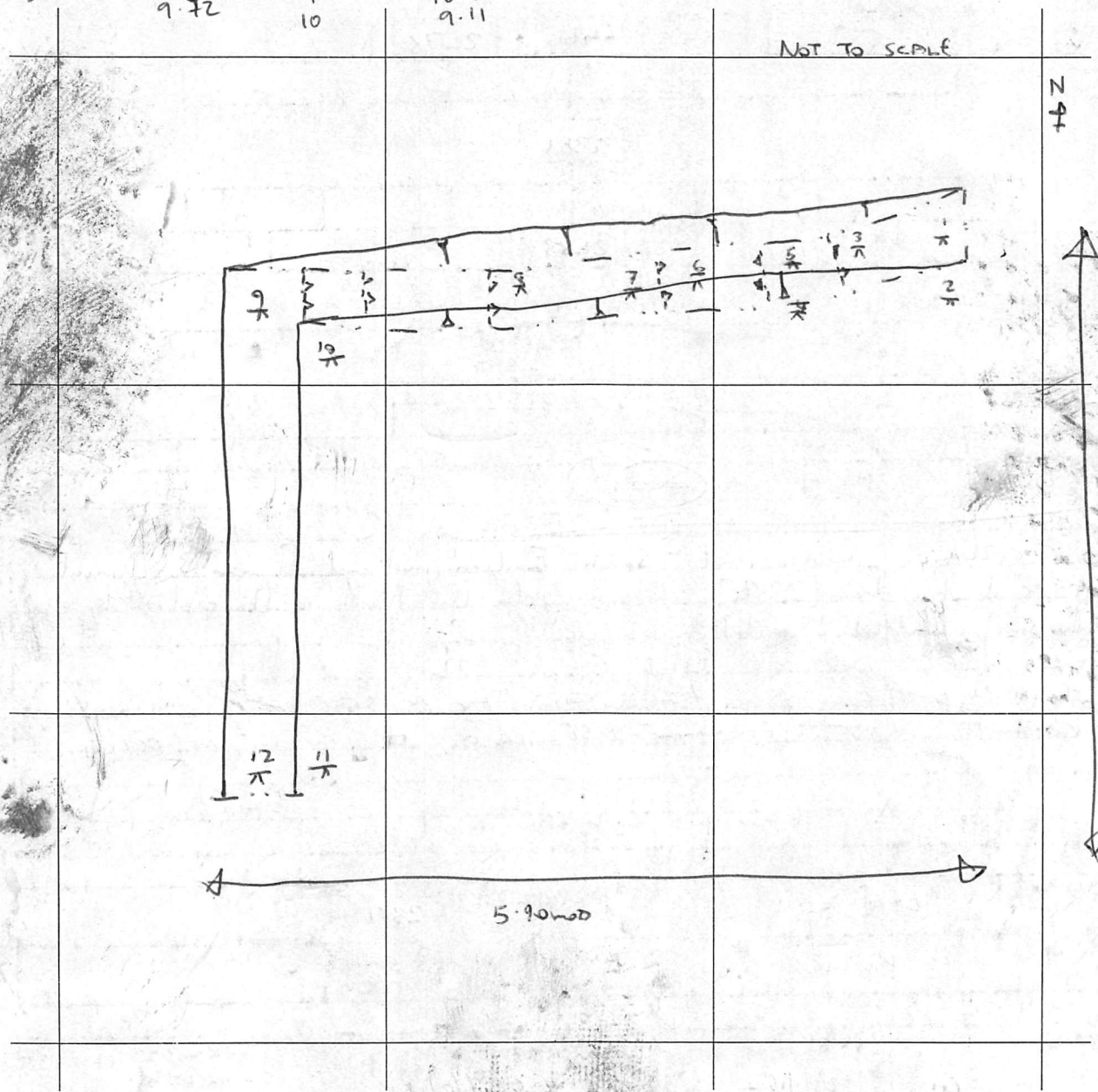

Site Code: MNO12	Location: <i>AREA</i>	Grid Sq:	Context Type: <i>Ct</i>	Context Number: <i>2484 2381 20FZ</i>
Deposit				Cut
1. Compaction				1. Shape in Plan
2. Colour				2. Corners
3. Composition				3. Dimensions
4. Inclusions				4. Break of slope - Top
5. Interface				5. Sides
6. Dimensions				6. Break of slope - Base
7. Other Comments				7. Base
8. Method/Conditions	Text			8. Orientation
				9. Inclination
				10. Truncation
				11. Other comments
				Max Level: m OD
				Min Level: m OD

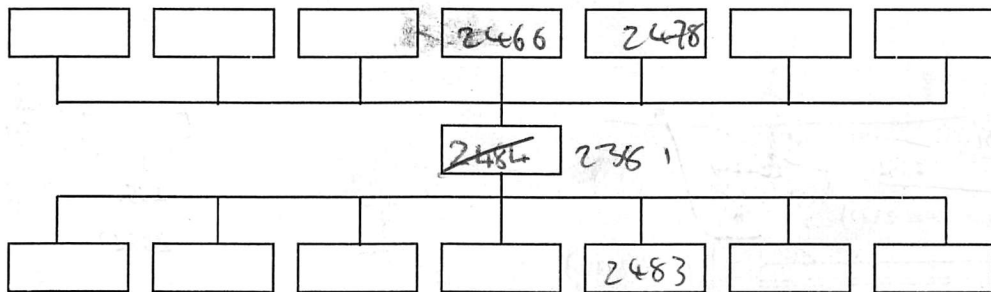

Interpretation:	Internal	External	Structural
Robb. cut	<i>see over for sketch + matrix</i>		
Context same as:			

Finds: None <input type="checkbox"/> Pot <input type="checkbox"/> Bone <input type="checkbox"/> Glass <input type="checkbox"/> Metal <input type="checkbox"/> CBM <input type="checkbox"/> Flint <input type="checkbox"/> Wood <input type="checkbox"/> Leather <input type="checkbox"/>	
Other (specify):	
Sample No(s):	Drawing No(s): <i>2484</i> (x)
Photo No(s):	Sketch/levels overleaf: <input type="checkbox"/> Transferred to plan: <input type="checkbox"/>

Compiled by:	Date:	Checked by:	Tick when entered in database: <input type="checkbox"/>
--------------	-------	-------------	---

Level No.s 1-2
TBM ~~11.80~~ 11.50
B/S 1.18
IH ~~12.98~~ 12.68

Level No.s
TBM
B/S
IH

Level No.s
TBM
B/S
IH

Level No.s
TBM
B/S
IH

No.	F/S	R/L (m OD)	No.	F/S	R/L (m OD)	No.	F/S	R/L (m OD)	No.	F/S	R/L (m OD)
1	2.22	10.76	10.46	(R)							
2	2.27	10.71	10.41								

EAST FACING SECTION
COLLAR [2381]

