

Site Code: MNO12	Location: ARCH B	Grid Sq: 115/210 115/215 110/210	Context Type: MASONRY	Context Number: 2073
1. Materials	1. Fill red orange bricks, orange tiles + York stone			
2. Size of materials (brick: BTL in mm)	2. Br.B.L. - 110x50x220mm			
3. Finish of stones	Tile - 270x50x290mm			
4. Coursing / bond	YS - 390x50x790mm			
5. Form	3. N/A			
6. Direction of face(s)	4. Dark yellowish grey			
7. Surface treatment	5. Floor			
8. Bonding material (if brick: record height of 4 courses & 4 bed joints in m)	6. Ceiling / Sky			
9. Dimensions of masonry as found	7. N/A			
10. Other comments	8. One course 0.05m OD			
	9. NS - 3.52m OD EW - 1.26m OD #			
	Thickness - 0.05m OD			
	Max Level: 11.16 m OD			
	Min Level: 11.12 m OD			

Stratigraphic Relationships:

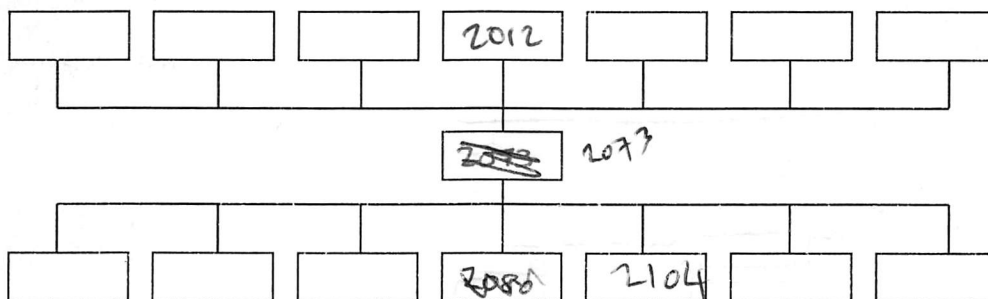

Physical Relationships:

Abuts:	Abutted by:
Cut by:	

Interpretation:	<u>internal</u>	external
Mixed floor of room at the western most part of site of 2 The Crescent; truncated to the West by modern concrete (+)		
DEPOSIT NOW ONLY INCLUDES SOUTHERN PART OF FLOOR WHICH WAS REMOVED AND REPLACED WHEN MANHOLE [2179] WAS CONSTRUCTED. THE NORTHERN PART OF THE FLOOR IS IN SITU. TM 22/1/15.		
Context same as:		

Sample No(s):	2x 2556C	Drawing No(s):	2073 (x2)
Photo No(s):	2219, 2229, 2235, 2237, 2247-8 2324-S, 2556	Sketch/levels overleaf:	<input checked="" type="checkbox"/>
		Transferred to plan:	<input type="checkbox"/>

Compiled by:	Date:	Checked by:	Tick when entered in database:
DB	14/01/15	3/1/15	<input type="checkbox"/>

Context Number:

2073

Level No.s 1-5

TBM 11.68

B/S 0.44

IH 12.12

Level No.s

TBM

B/S

IH

Level No.s

TBM

B/S

IH

Level No.s

TBM

B/S

IH

No.	F/S	R/L (m OD)	No.	F/S	R/L (m OD)	No.	F/S	R/L (m OD)	No.	F/S	R/L (m OD)
1	0.99	11.13									
2	0.98	11.14									
3	0.96	11.16									
4	1.00	11.12									
5	0.98	11.14									

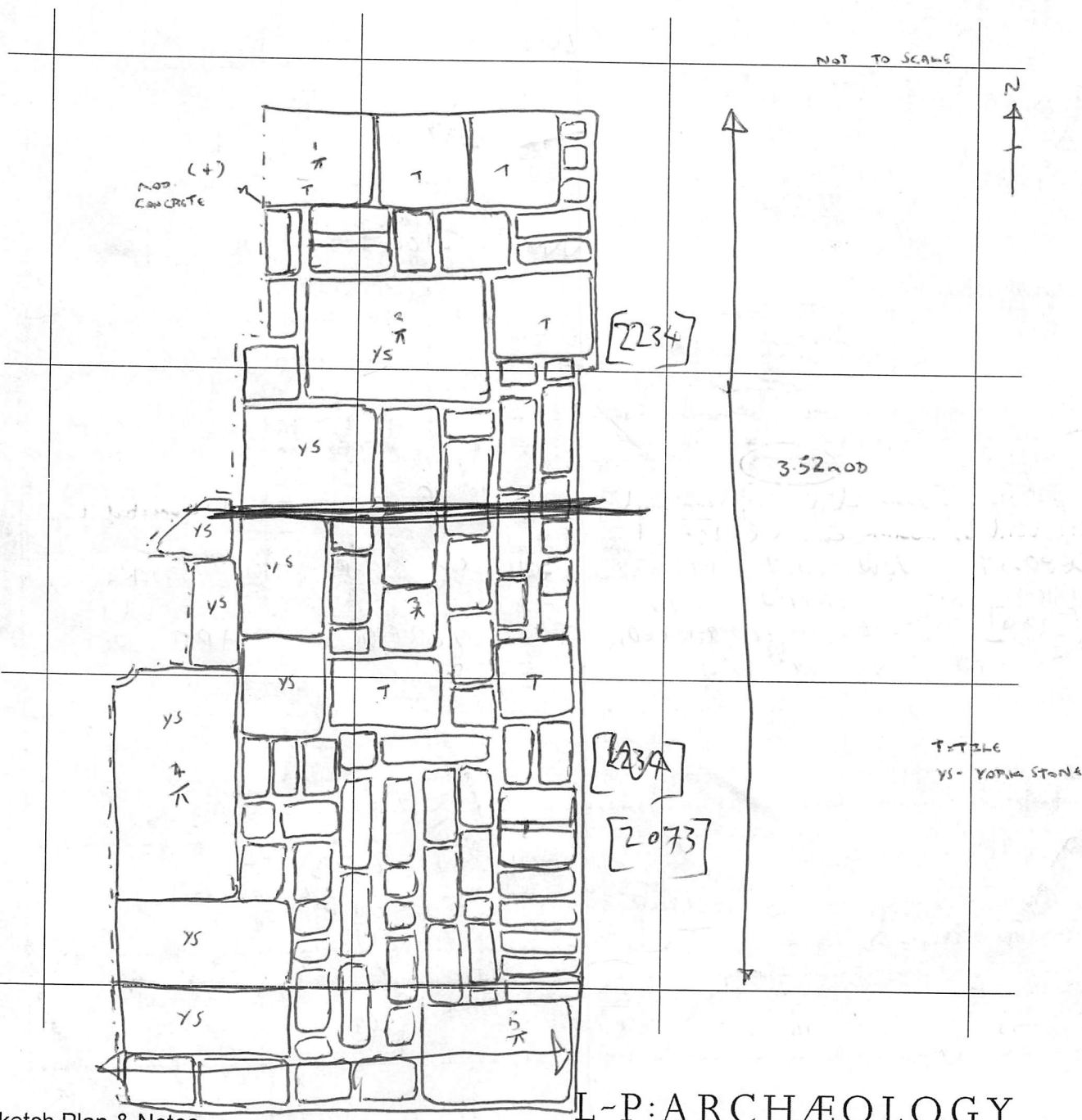

Sketch Plan & Notes